

| | | | | |
|-------------|--------------------------|------|-------|-------|
| PART NO. | JLL-301 | WIRE | SCALE | 1 : 1 |
| DESCRIPTION | SJT#16*3C 60C SHIELDED | | UNIT: | mm |
| DWG No. | 800-1601-0-SJT0-BL-00150 | | | |

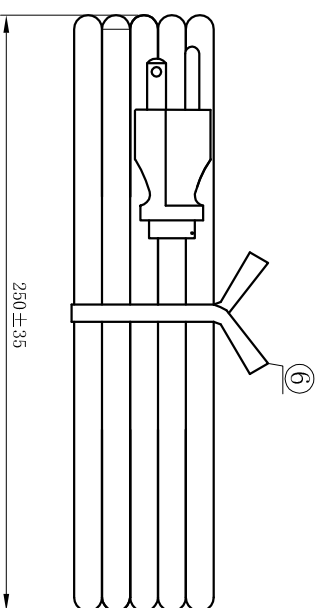
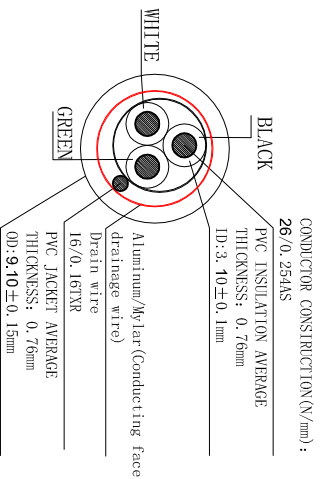
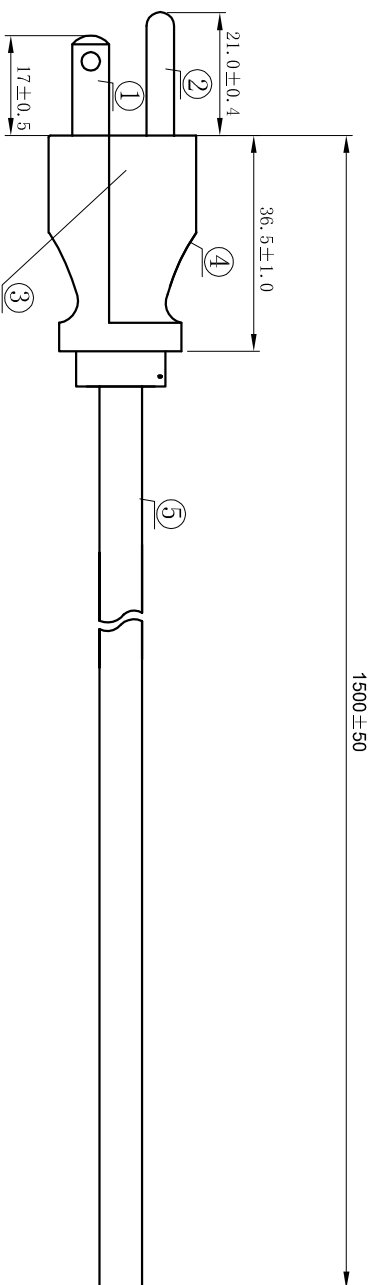
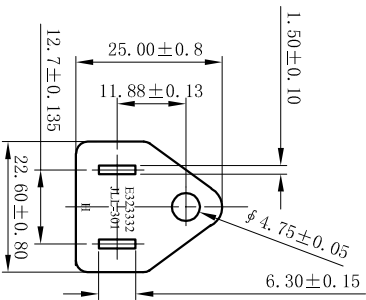

NOTES:

- 1) JACKET COLOR: BLACK
 - 2). E-GREEN ; L-BLACK ; N-WHITE
- TESTING:
- 1) 100% OPEN & SHORT TESTING
 - 2) INSULATION RESISTANCE: 100M ohm (min)
 - 3) VOLTAGE: DC500V/1min
 - 4) ROHS COMPLIANT

Printing the contents of wire The use of printing ink replenish Wire

E243929 (UL) SJT 3X16AWG(1.31mm²) VW-1 SHIELDED 60°C 300V CSA 228191 SJ
T 3X16AWG(1.31mm²) FT2 SHIELDED 60°C 300V -1P-

| NO. | SPECIFICATION | COLOUR | MATERIAL | AMOUNT |
|-----|--------------------------|--------|----------|--------|
| ① | Load terminals 98861 | Silver | Cu | 2P |
| ② | Grounding terminal 97475 | Silver | Cu | 1P |
| ③ | Model aircraft 8661AW-3P | WHITE | PBT | 1PCS |
| ④ | Plug JLL-301 | BLACK | PVC Cu | 1PCS |
| ⑤ | Wire SJT 16AWG/3C 60° | BLACK | PVC Cu | 1PCS |
| ⑥ | Ties | BLACK | | 1PCS |

| REV | DATE | DESCRIPTION | SYMBOL |
|--------------|--------------|--------------|--------|
| DRAWN/DATE | CHECKED/DATE | GONG/10.11.3 | |
| GONG/10.11.3 | | ZHU/10.11.3 | |