

LOADING PATTERN MATING SIDE

f	0	0	0	0	0	0	0	0	0	0
e	4	4	4	4	4	6	6	6	6	6
d	4	4	4	4	4	4	4	4	4	6
c	4	4	4	4	4	4	4	4	4	6
b	4	4	4	4	4	4	4	4	4	4
a	4	4	4	4	4	6	6	6	6	6
z	0	0	0	0	0	0	0	0	0	0
POS	01				05					10

LOADED CONNECTOR ASSEMBLY
(FOR EXAMPLE)

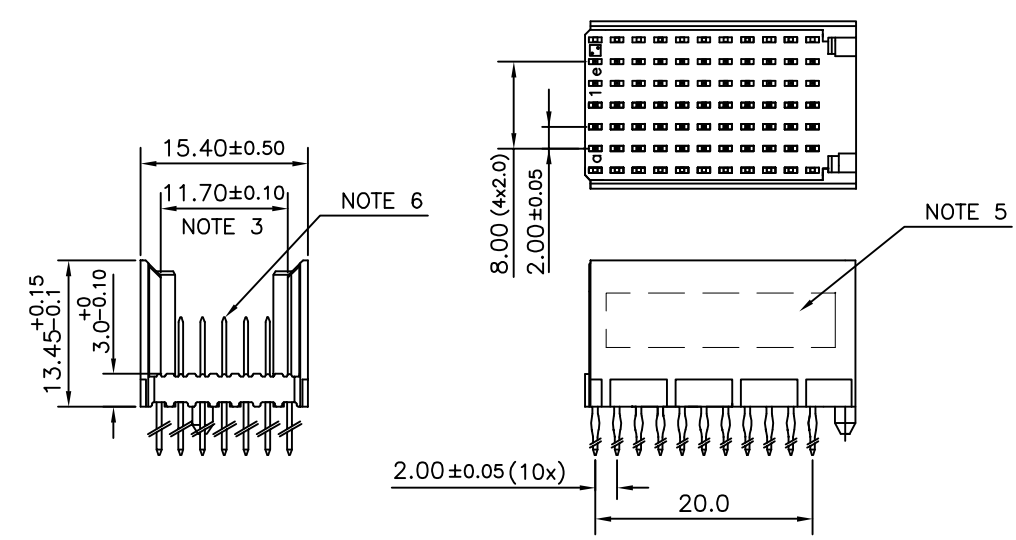

CONTACT OVERVIEW

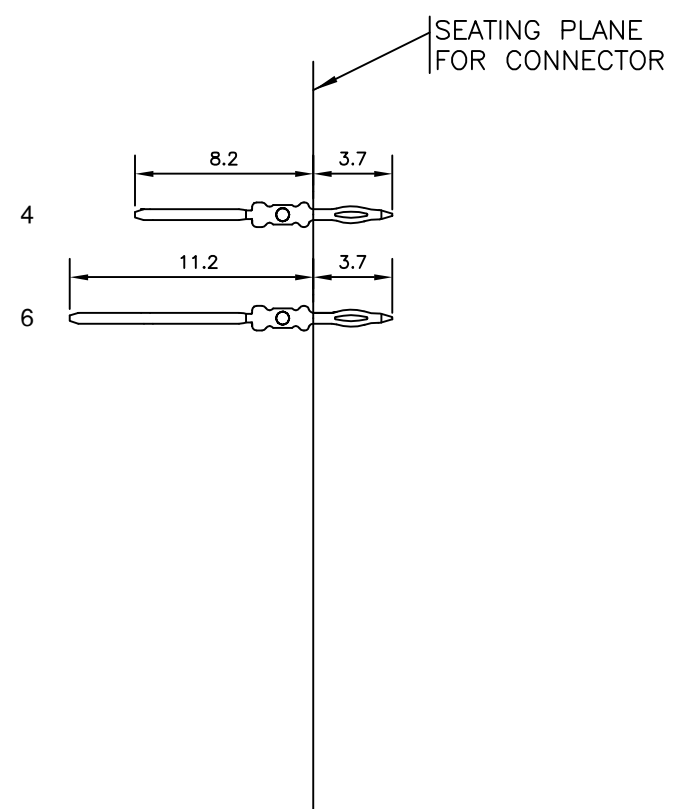

LAY-OUT P.C.B.-HOLE

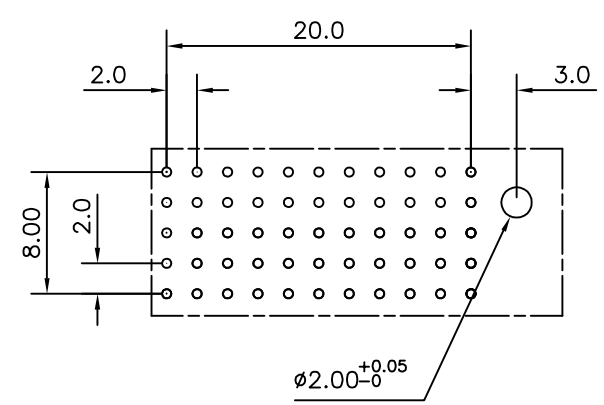

HM2P09PDH3U0 **LEAD FREE INDICATOR : LF = LEAD FREE (DIGIT 15 & 16)**
PLATING CODE (DIGIT 13 AND 14)
 (REF DRW NO. BS,C , 201844 , 003)

NOTES

1. THIS PRODUCT IS CSA APPROVED.
2. THIS PRODUCT IS UL RECOGNIZED.
3. MEASURED AT THE BOTTOM.
4. MATERIAL CONTACT: PHOSPHORBRONZE
HOUSING: CREAM WHITE GLASS FILLED POLYESTER UL-94V0
5. CONNECTOR PRINTED WITH P/N AND DATE CODE.
6. FOR ACTUAL CONTACT LOADINGS, SEE LOADING PATTERN MATING SIDE.
7. SHAPE OF CONNECTOR HOUSING CAN ALTER DEPENDING ON PRODUCTION LOCATION
8. THIS PRODUCT (LF) MEETS EUROPEAN UNION DIRECTIVES AND OTHER COUNTRY REGULATIONS AS DESCRIBED IN GS-22-008
9. FOR RECOMMENDED PTH DIMENSIONS REFER DRAWING : BS, A , 201572 , 001

CATALOG NO: HM2P09PDH3U0----

mat'l. code SEE NOTE - 4		surface ISO 1302 ✓	tolerance ISO 406 ISO 1101	projection 	product family MILLIPACS
ltr A	ecn no 106-0050	dr MINI	date 03/05/2006	angles linear 0°±1°	title MILLIPACS 5+2R STR HDR CONN TYPE C
		dr MINI K VANDANATH	03/05/2006	linear .00±0.1	scale mm
		enr BIJU K PAUL	03/05/2006	linear .000±.00x	dwg no BS, C , 203028, 701
		chr BIJU K PAUL	03/05/2006	linear .000±.00x	sheet 1 of 1 size A3
		appd SOMASUNDARAM	03/05/2006	linear .000±.00x	type Product Customer Drawing
sheet index	revision sheet				



Copyright FCI