

THIS DRAWING IS UNPUBLISHED. RELEASED FOR PUBLICATION 2003
 © COPYRIGHT 2003 BY TYCO ELECTRONICS CORPORATION. ALL RIGHTS RESERVED.

LOC	DIST	REVISIONS					
AP	-	P	LTR	DESCRIPTION	DATE	DWN	APVD
			P1	REV PER ECO-09-026444	27NOV09	KK	AEG
			P2	REV. BY ECO-10-006997	09APR10	HC	WLS

CAD
 Pro-
 DO NOT REVISE
 EXCEPT BY CAD

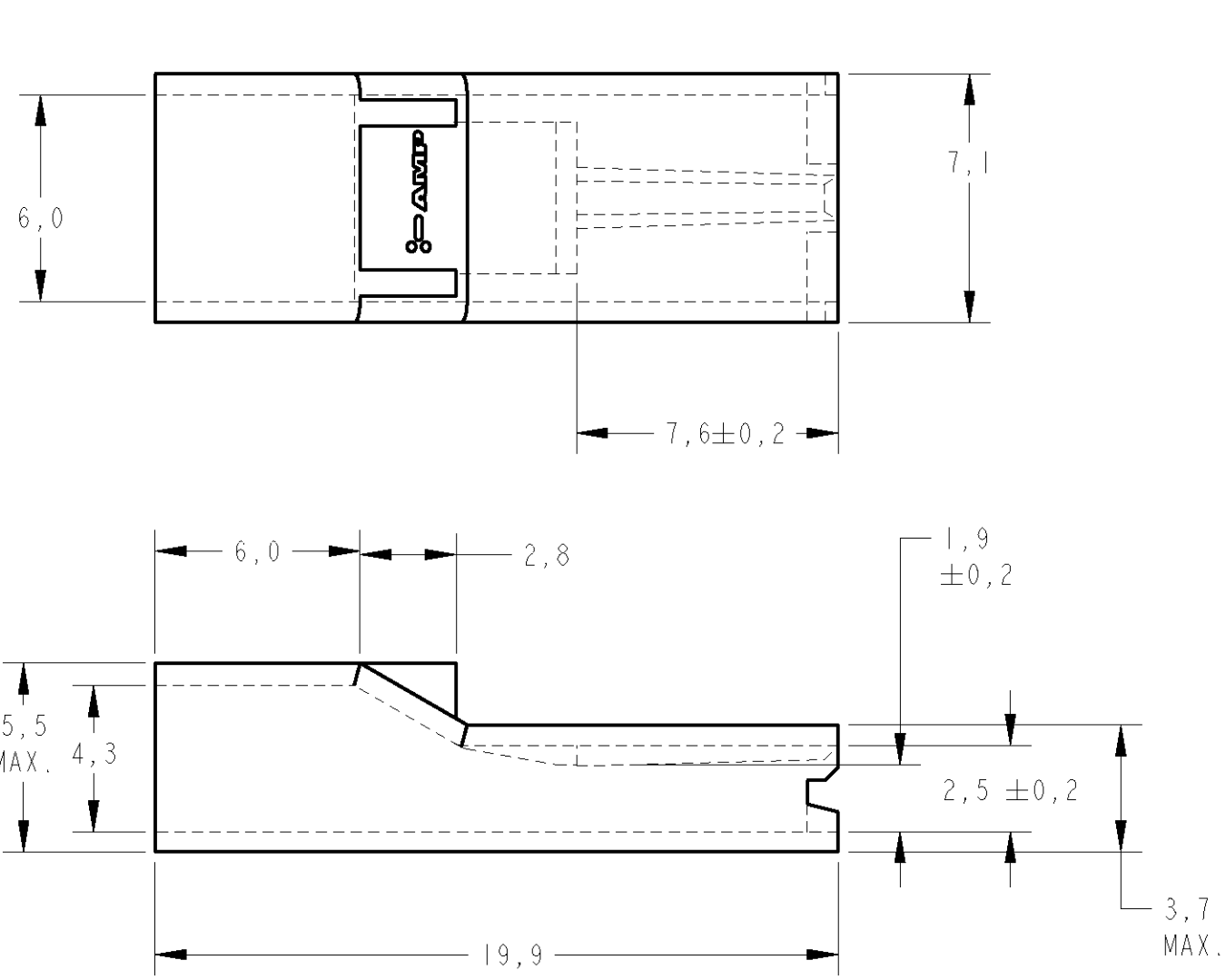

NATURAL	$\triangle 1$	2-880488-2
NATURAL	PA6.6V0 OR PA6.6V0+PA6V0	2-880488-1
AMARELO/YELLOW	PA 6.6	1-880488-5
VERMELHO/RED	PA 6.6	1-880488-4
AZUL/BLUE	PA 6.6	1-880488-3
PRETO/BLACK	PA 6.6	1-880488-2
NATURAL/NATURAL	PA 6.6	1-880488-1
VERMELHO/RED	POLIPROPILENO/POLYPROPYLENE	880488-4
AZUL/BLUE	POLIPROPILENO/POLYPROPYLENE	880488-3
NATURAL/NATURAL	POLIPROPILENO/POLYPROPYLENE	880488-2
PRETO/BLACK	POLIPROPILENO/POLYPROPYLENE	880488-1

OBSOLETE
 $\triangle 2$

$\triangle 1$ - MATÉRIA-PRIMA CONFORME ESPECIFICAÇÃO IEC 60335-1, GWT 750°C, SEM CHAMA.
 RAW MATERIAL ACC. TO SPEC. IEC 60335-1, GWT 750°C, WITHOUT FLAME.

$\triangle 2$ - OBSOLETE PARTS: OBSOLETE CIS STREAMLINING PER D.RENAUD/D.SINISI

THIS DRAWING IS A CONTROLLED DOCUMENT FOR TYCO ELECTRONICS CORPORATION IT IS SUBJECT TO CHANGE AND THE CONTROLLING ENGINEERING ORGANIZATION SHOULD BE CONTACTED FOR THE LATEST REVISION.		DWN M.R.BRIZ 05SEP2003	Tyco Electronics TYCO ELECTRONICS do Brasil LTDA. São Paulo, Brasil	
DIMENSIONS: mm		CHK P.L.FARIA 05SEP2003	NAME .187 S. FASTON RECEPTACLE HOUSING	
TOLERANCES UNLESS OTHERWISE SPECIFIED: 0 PLC ±- 1 PLC ±0,5 2 PLC ±- 3 PLC ±- 4 PLC ±- ANGLES ±-		APVD D.A.OLIVEIRA 05SEP2003	PRODUCT SPEC N/A	
MATERIAL SEE TABLE		APPLICATION SPEC N/A	RESTRICTED TO	
FINISH SEE TABLE		WEIGHT -	SIZE A3	CAGE CODE 00779
CUSTOMER DRAWING		DRAWING NO C-880488		SCALE 5:1
		SHEET 1		OF 1
		REV P2		