

DETAILS

| | |
|------------------------|----------------------------|
| Product Number | CN13523_MIRELLA-50-S-CL-PF |
| Family | Mirella |
| Type | RefPack |
| Color | metal |
| Diameter | 49,9 mm |
| Height | 25,5 mm |
| Style | round |
| Optic Material | PC |
| Holder Material | |
| Fastening | glue, screw |
| Status | production ready |
| ROHS Compliant | Yes |
| Date Updated | 1/11/2016 |



OPTICAL PROPERTIES

| LED | Viewing | Light | Effi- | | Connector |
|-----------------------|---------|-------|-----------|------------|--------------|
| | Angle | Beam | ciency | cd/lm | |
| CLL02x/CLU02x (LES10) | 18 deg | Spot | 83 % | 5.100 | - |
| CLL01x | 13 deg | Spot | 84 % | 7.600 | - |
| CLU700/701 | 13 deg | Spot | 83 % | 6.600 | - |
| MT-G | 18 deg | Spot | 86 % | 5.500 | - |
| MT-G2 | 16 deg | Spot | 84 % | 5.800 | - |
| XHP50 | 12 deg | Spot | 84 % | 7.600 | - |
| XHP70 | 16 deg | Spot | 83 % | 5.300 | - |
| MHD-E/G | 15 deg | Spot | 87 % | 5.400 | - |
| COB 4W | 13 deg | Spot | 84 % | 7.800 | - |
| CXM-9 | 21 deg | Spot | 85 % | 3.300 | - |
| Duris S10 | 13 deg | Spot | 81 % | 6.500 | LEDiL: LEDiL |
| Soleriq S9 | sim: 24 | Spot | sim: 87 % | sim: 2.900 | - |
| ZC4/6 | 19 deg | Spot | 83 % | 4.300 | - |

Relative intensity of CN13523_MIRELLA-50-S-CL-PF-(CLL020)

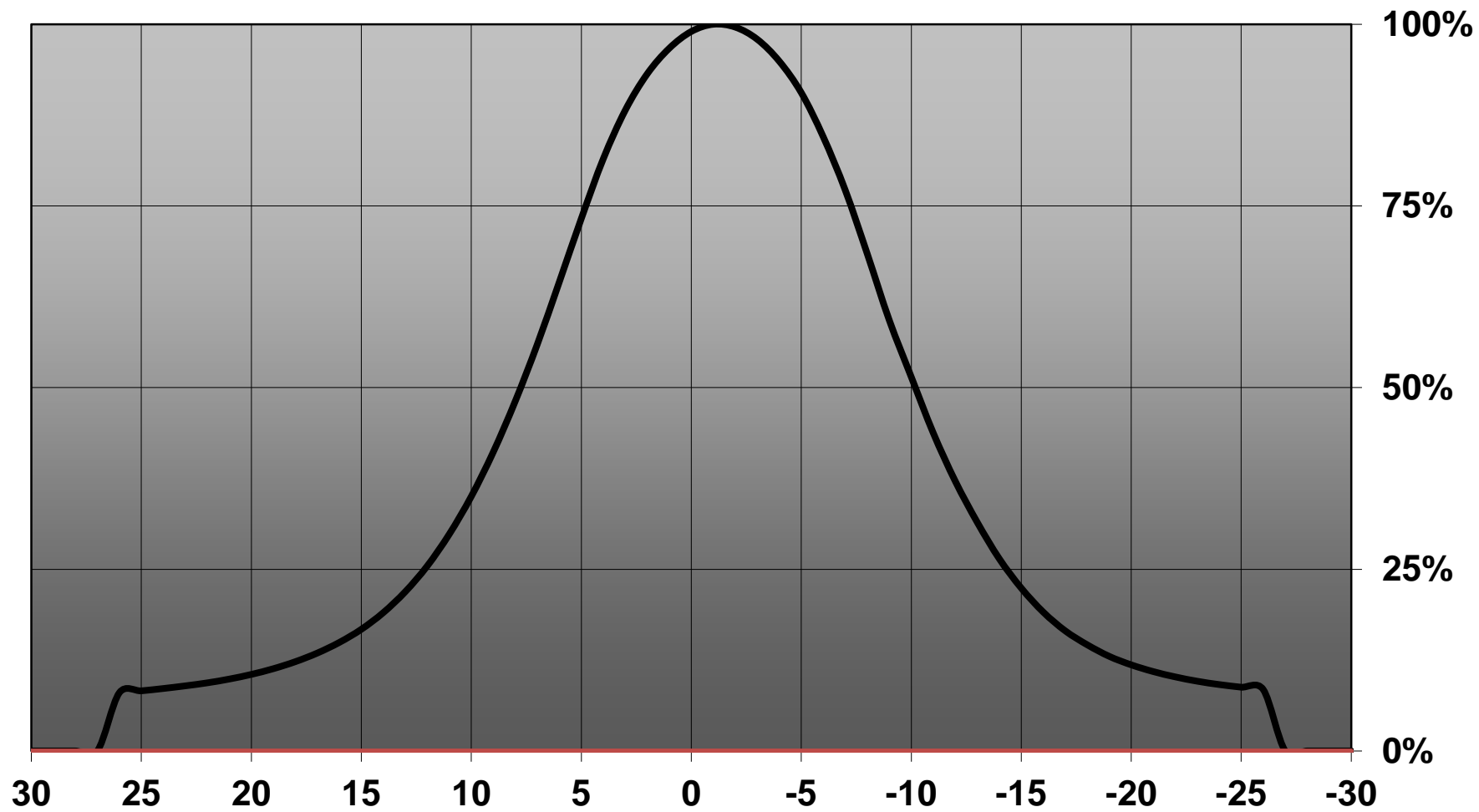

Relative intensity of CN13523_MIRELLA-50-S-CL-PF-(CLL010)

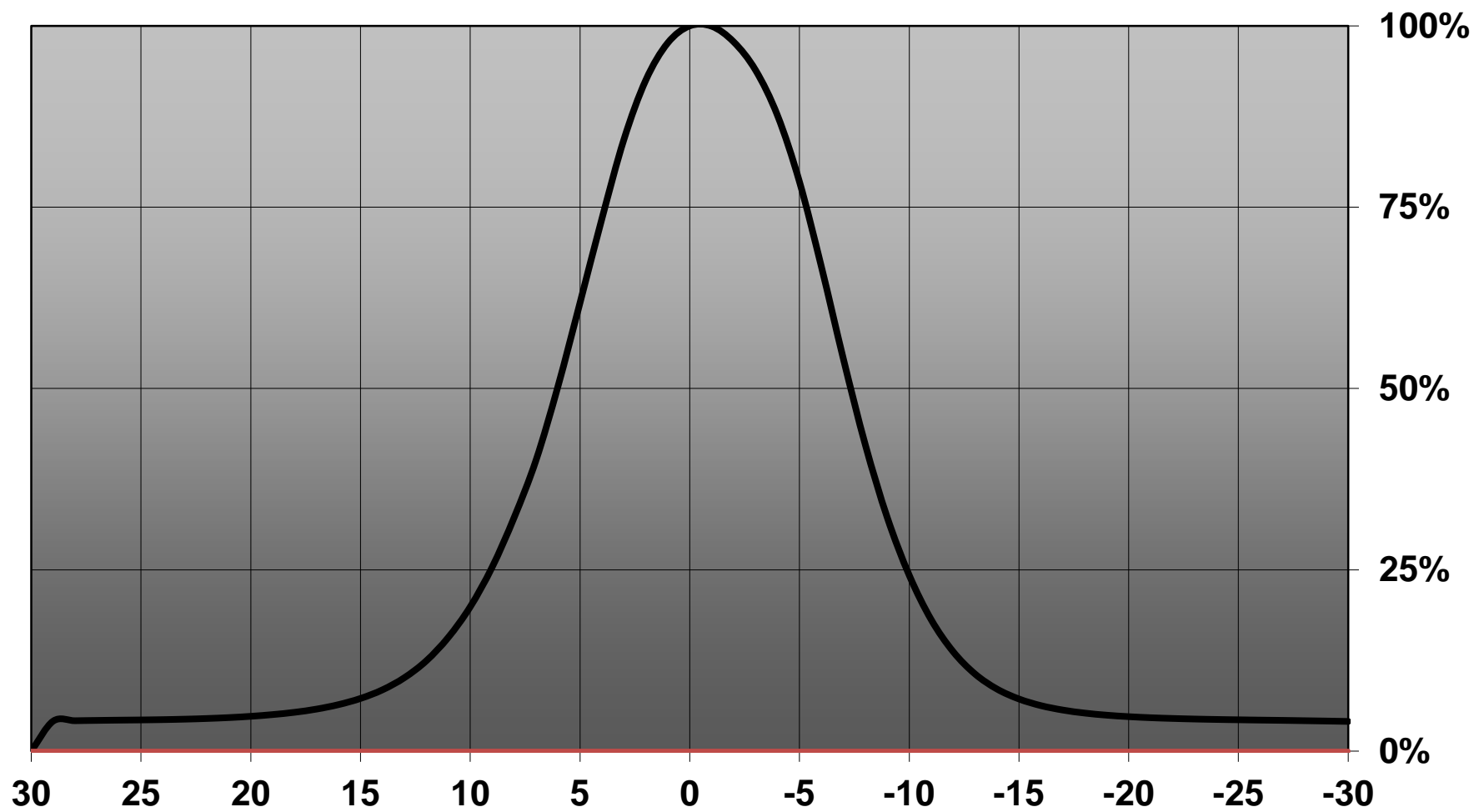

Relative intensity of CN13523_MIRELLA-50-S-CL-PF-(MTG)

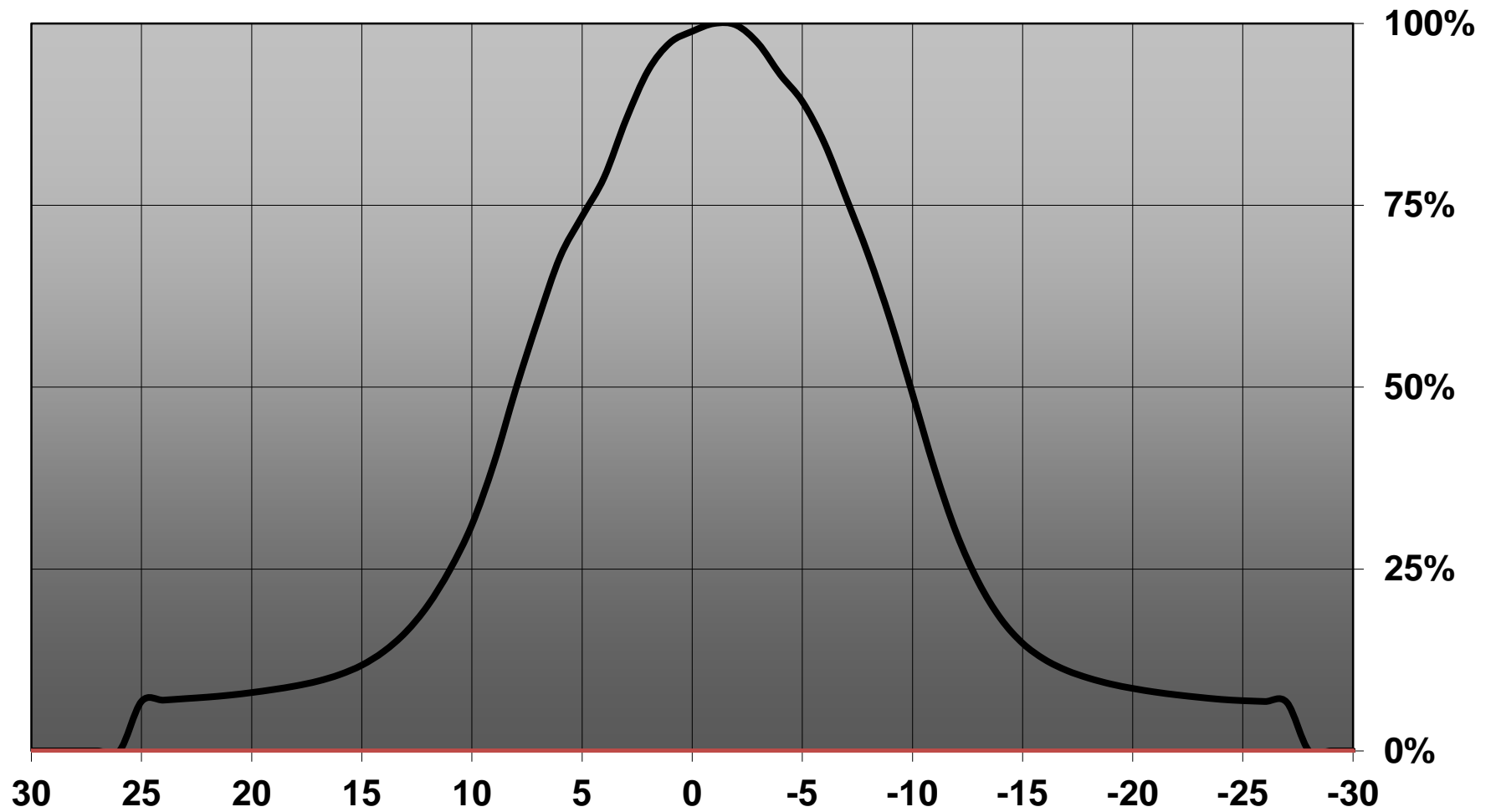

Relative intensity of CN13523_MIRELLA-50-S-CL-PF-(MTG2)

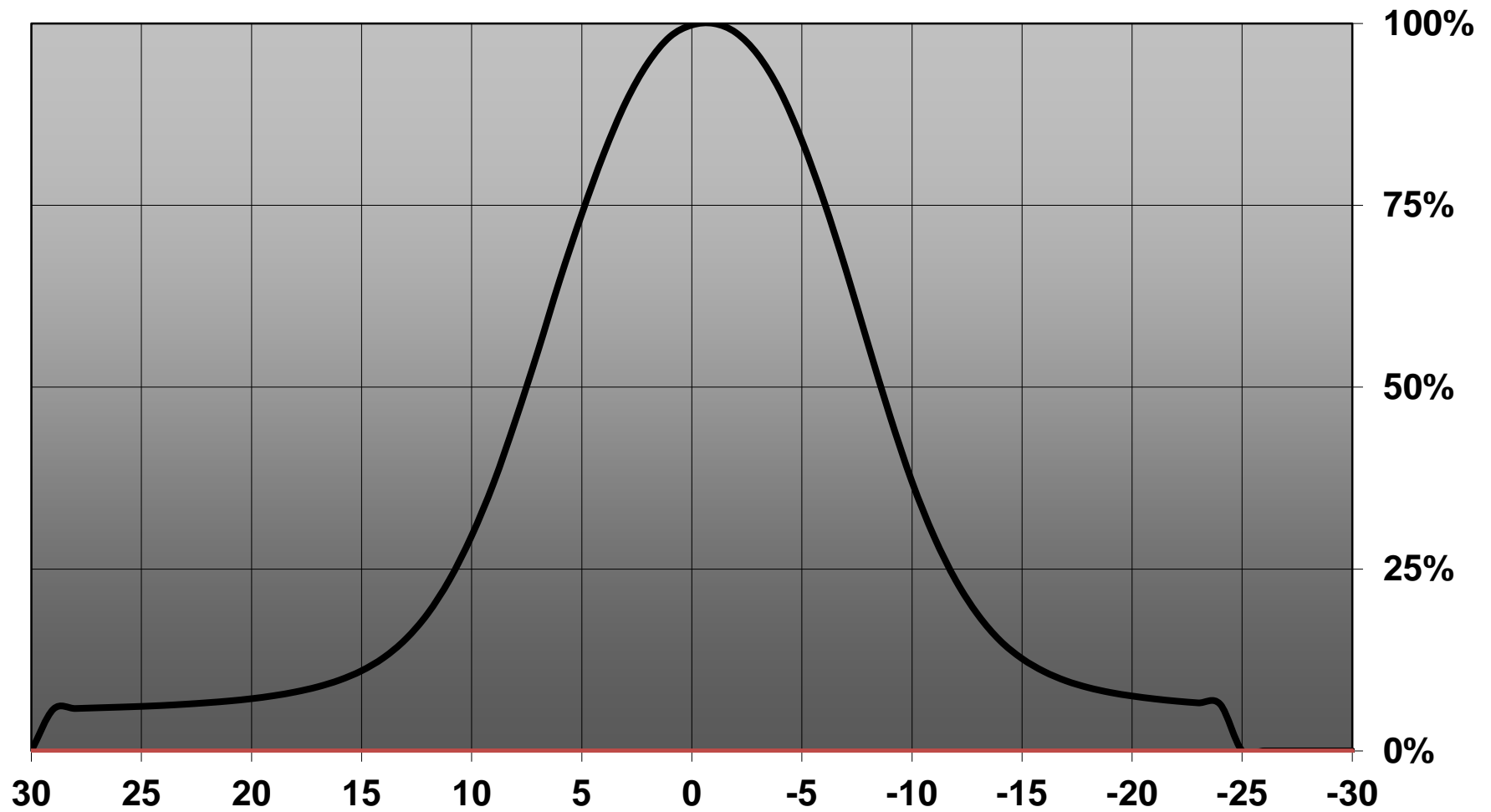

Relative intensity of CN13523_MIRELLA-50-S-CL-PF-(LG4W)

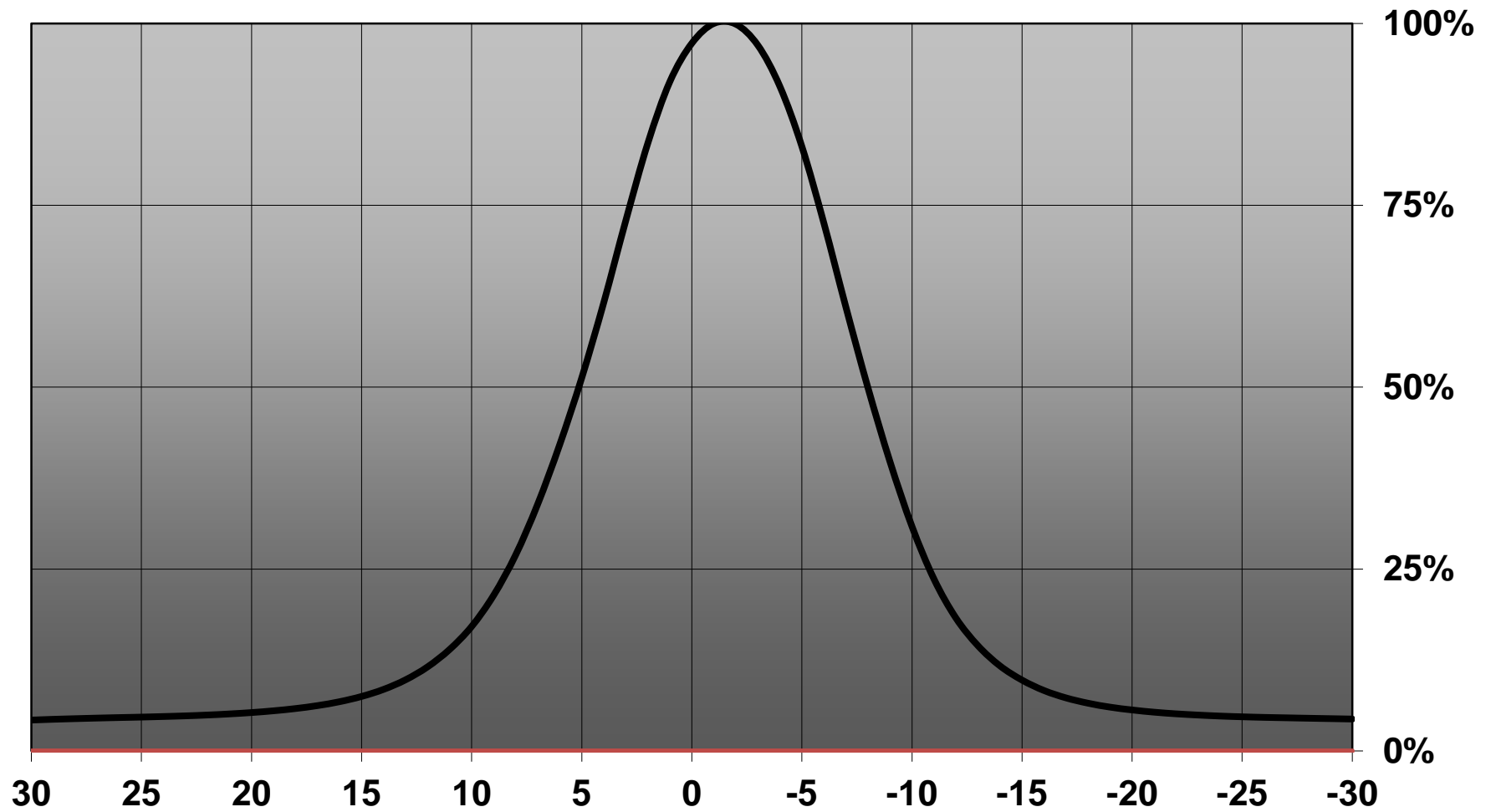

D

C

B

A

4

4

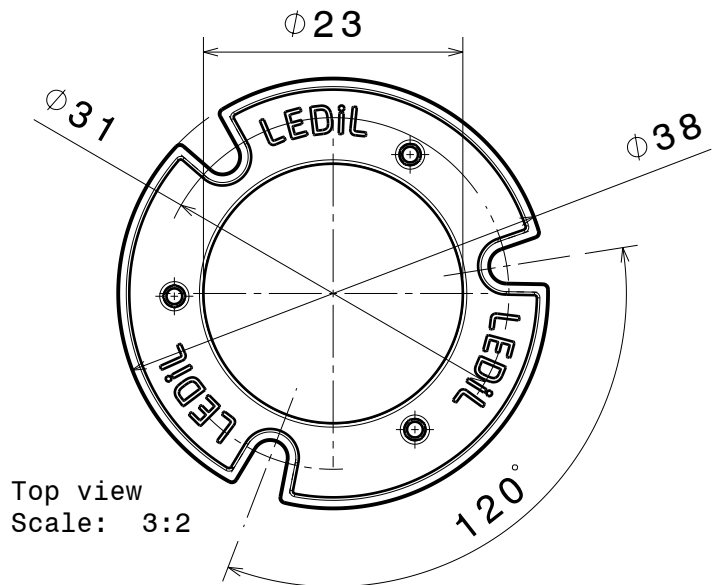

Top view
Scale: 3:2

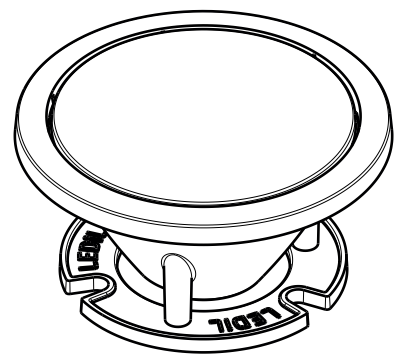

Isometric view

3

3

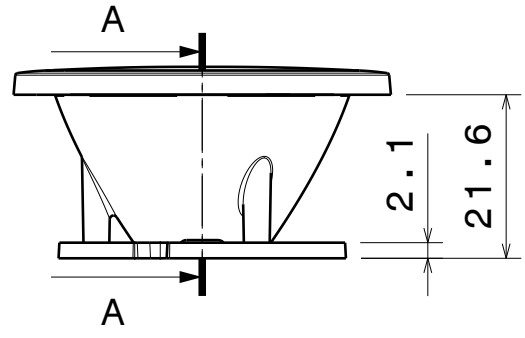

Front view

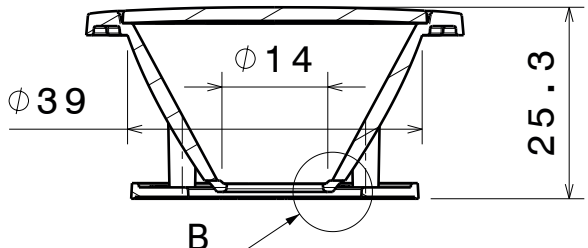

Section view A-A

2

2

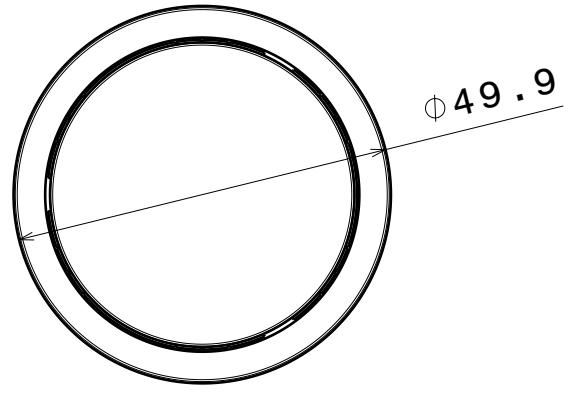

Top view

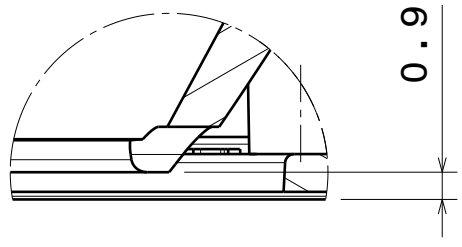

Detail B

NOTE: It is recommended to use glue like DELO-PUR 9895 for pin fastening.
[http://www.delo.de/fileadmin/datasheet/DELO-PUR_9895_\(TIDB-GB\).pdf](http://www.delo.de/fileadmin/datasheet/DELO-PUR_9895_(TIDB-GB).pdf)

This drawing is our property.
 It can't be reproduced
 or communicated without
 our written agreement.



Ledil Oy
 Salorankatu 10
 FIN 24240 SALO
 Finland

DRAWING TITLE Mechanical drawing

DRAWN BY
as

DATE
28.8.2012

MIRELLA-DL-PF

CHECKED BY
VS

DATE
28.8.2012

SIZE
A4

REV
001

DESIGNED BY
as

DATE
-

SCALE 1:1

WEIGHT -

SHEET 1/1

D

A

1

1

Luminaire: LEDiL Oy CN13523_MIRELLA-50-S-CL-PF_(CLU700)

Lamps: 1 x Citizen_CLU700_C13083_PF-SOCKET_394.785lm@100mA_P=2.92999W_I=0.1044A

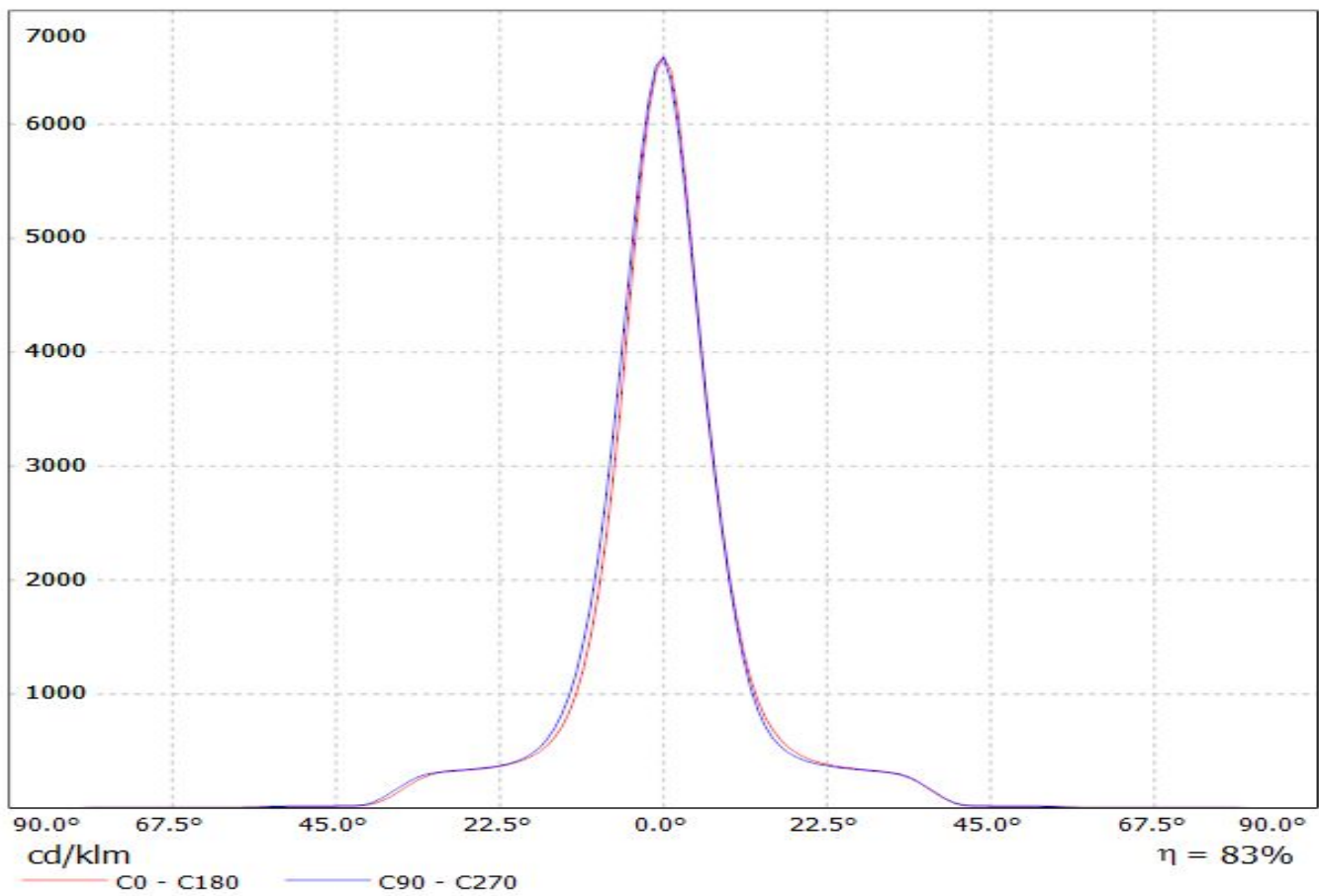

Luminaire: LEDiL Oy CN13523_MIRELLA-50-S-CL-PF_(CREE_XHP50_WARM_WHITE)
Lamps: 1 x CREE_XHP50_WARM_WHITE_195.491lm@250mA_P=1.39994W_η=0.2499A

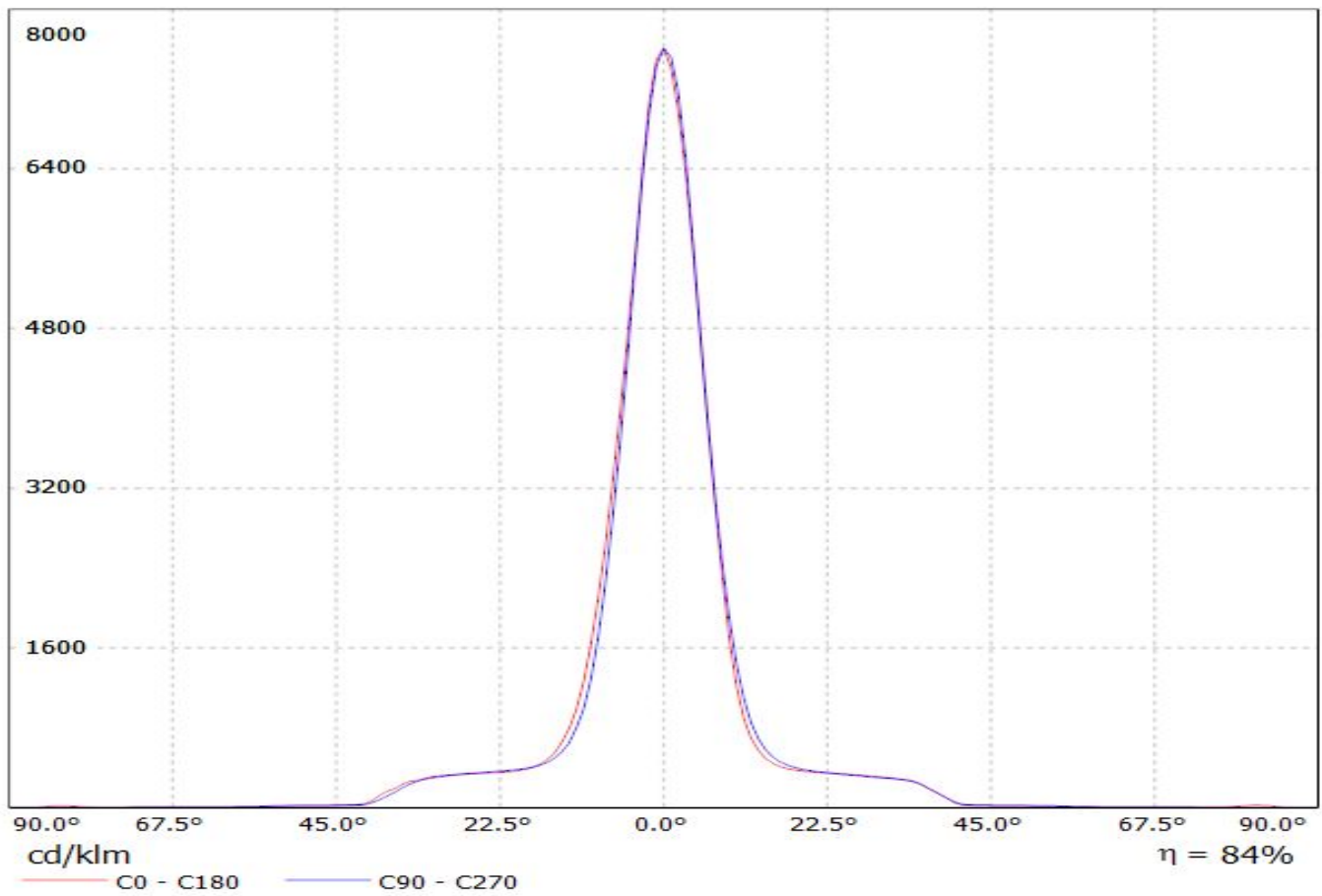

Luminaire: LEDiL Oy CN13523_MIRELLA-50-S-CL-PF_(CREE_XHP70)
Lamps: 1 x CREE_XHP70_260.212lm@250mA_P=1.383W_I=0.2499A

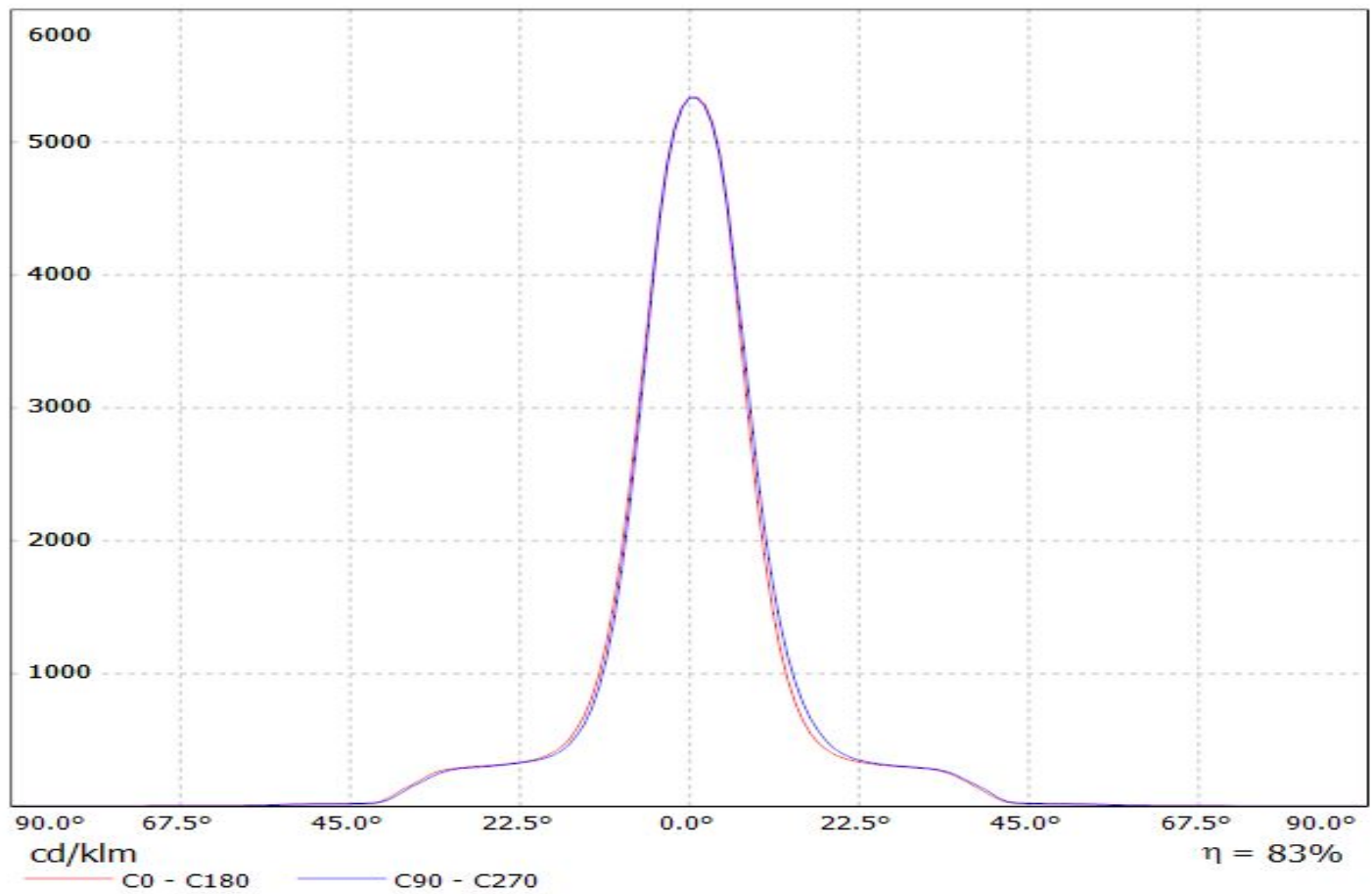

Luminaire: Ledil CN13523_MIRELLA-50-S-CL-PF_(MHD-G)
Lamps: 1 x Cree MHD-G_530.44lm@100mA_P=3.0W_I=0.100A

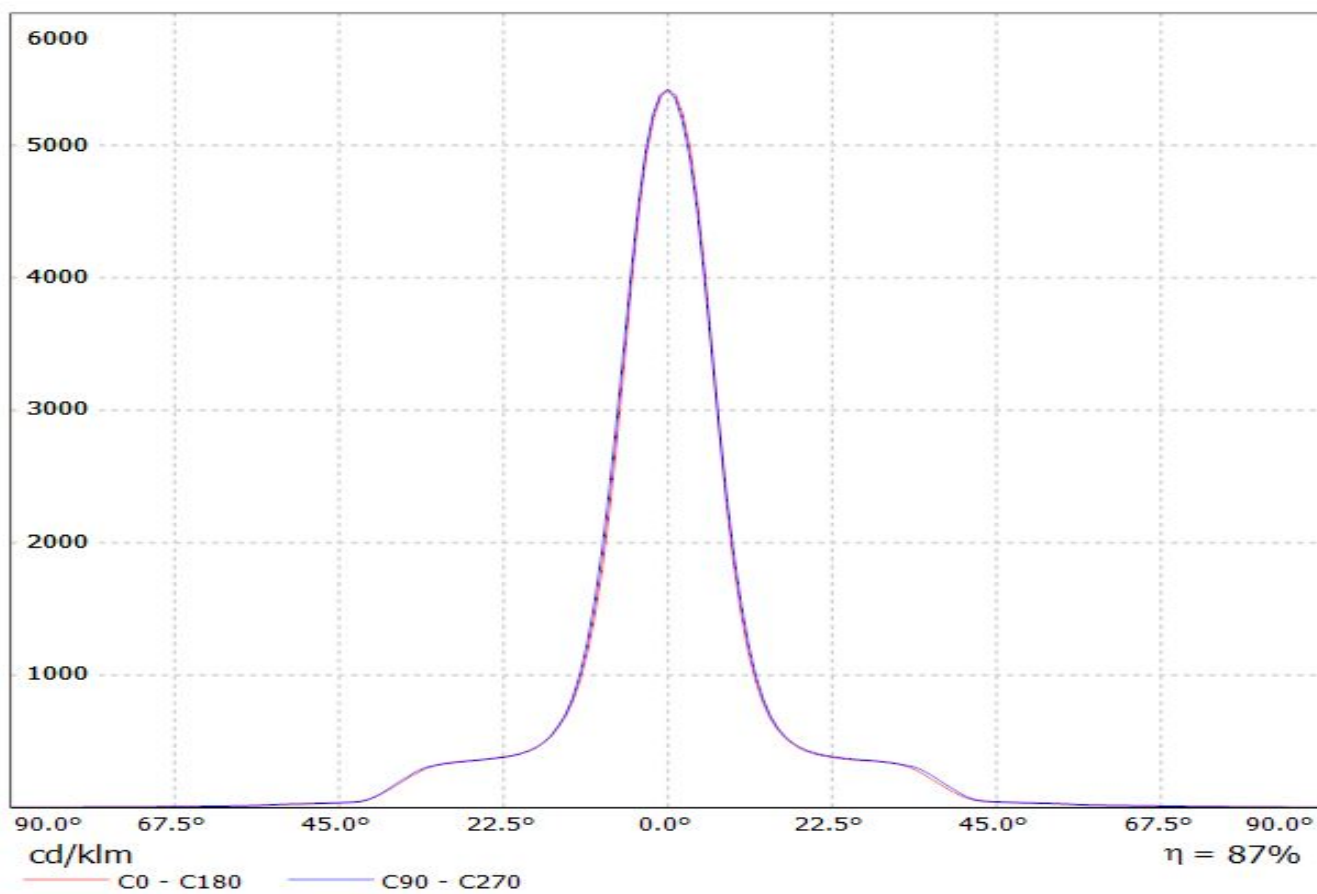

Luminaire: LEDiL Oy CN13523_MIRELLA-50-S-CL-PF_(CXM-9)

Lamps: 1 x Luminus_XNOVA_CXM-9_(AA00)_974.297lm@240mA_P=8.2836W_I=240mA

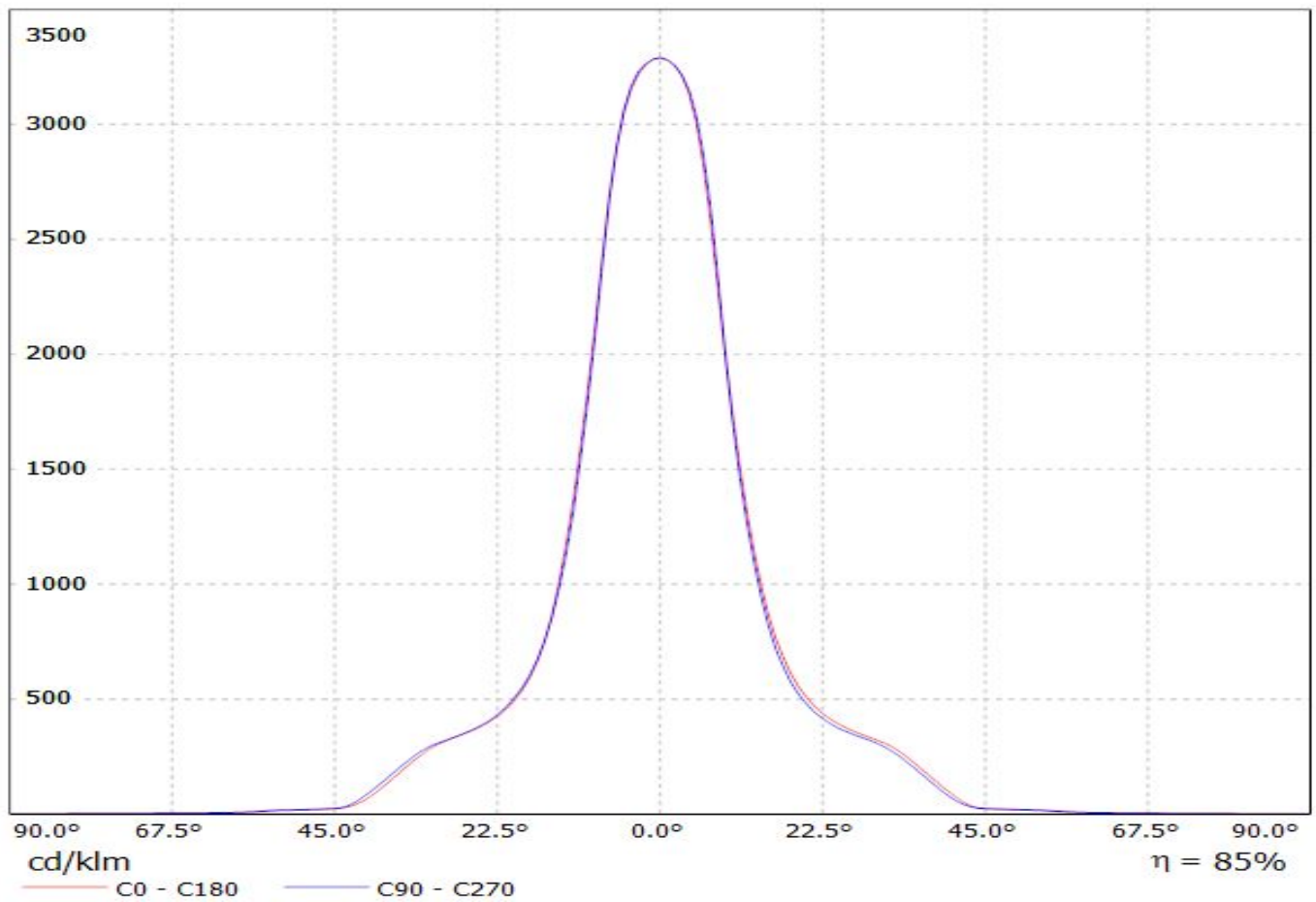

Luminaire: Ledil CN13523_MIRELLA-50-S-CL-PF_(Duris_S10)

Lamps: 1 x Osram_Duris_S10_(GWP7LM32.CM)_298.59lm@100mA_P=2.52277W_I=0.1A

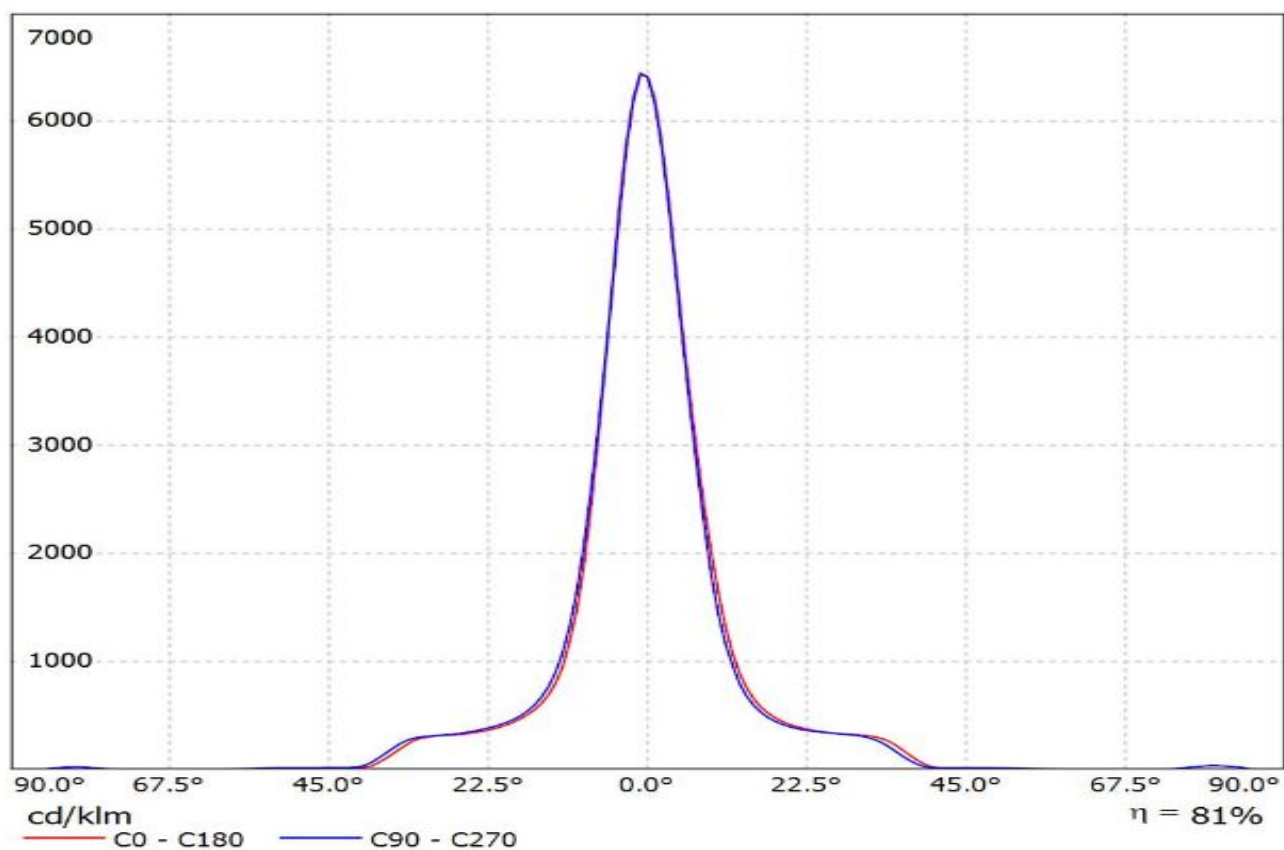

Luminaire: Ledil Oy CN13523_MIRELLA-50-S-CL-PF_(Soleriq_S9)_SIMULATED
Lamps: 1 x Osram Soleriq S9 (GW KAFJB3.EM)

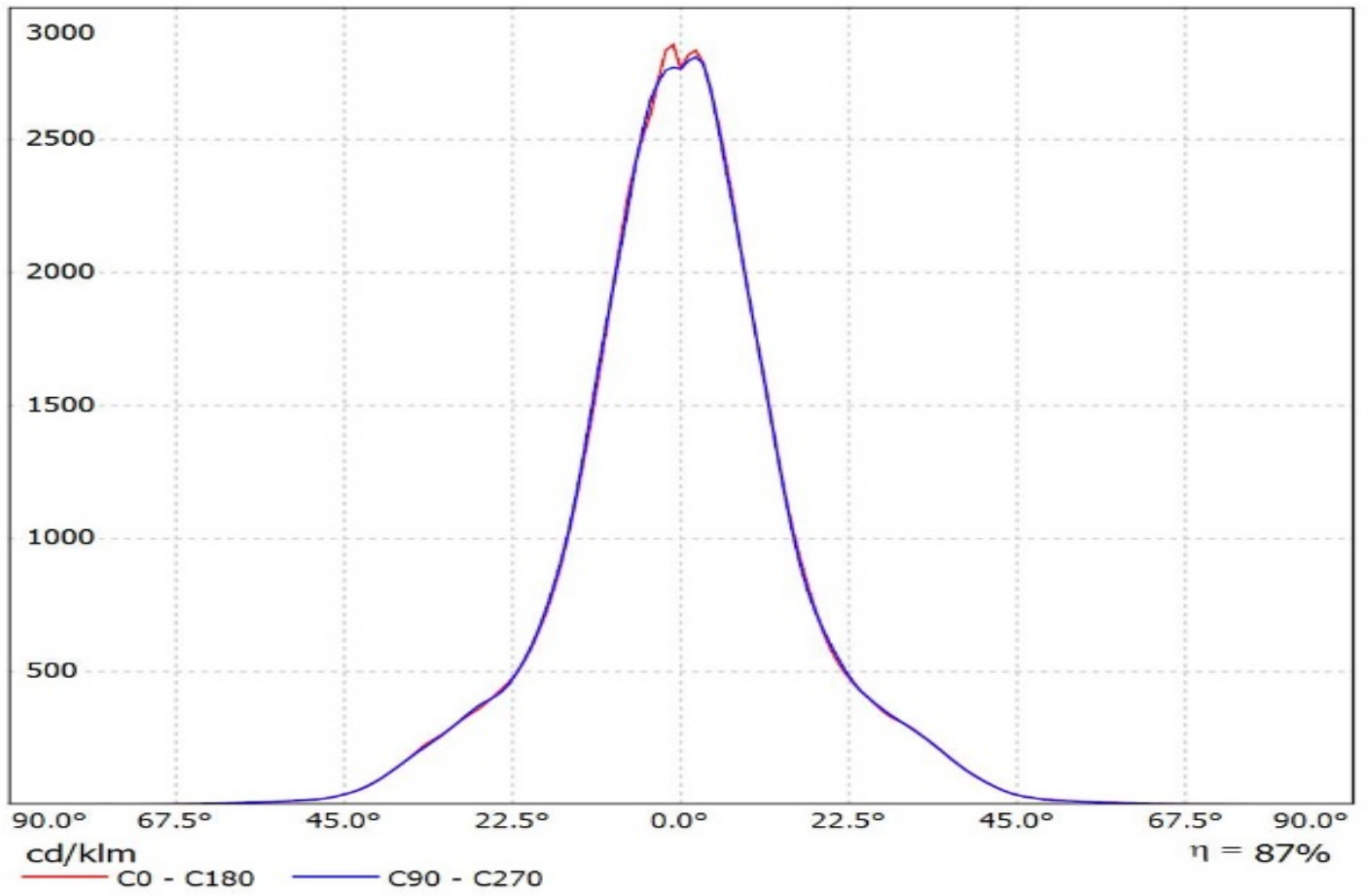

Luminaire: LEDil Oy CN13523_MIRELLA-50-S-CL-PF_(ZC6) Efficiency=82%
Lamps: 1 x Seoul ZC6 (SDW81F1C) 422lm @ 100mA CCT=3100K P=3.4W I=100mA

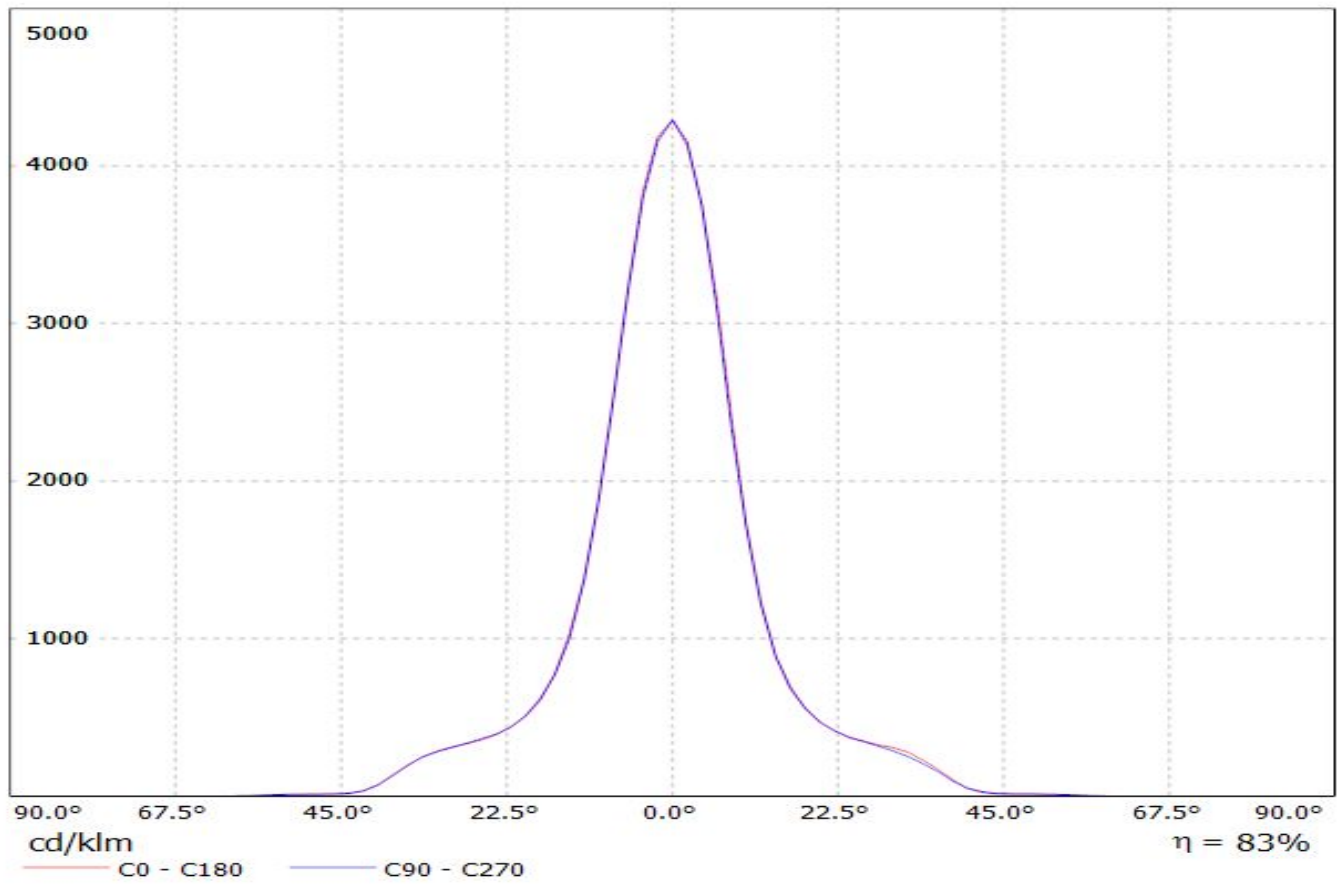

Luminaire: LEDiL Oy CN13523_MIRELLA-50-S-CL-PF_(CLU700)

Lamps: 1 x Citizen_CLU700_C13083_PF-SOCKET_394.785lm@100mA_P=2.92999W_I=0.1044A

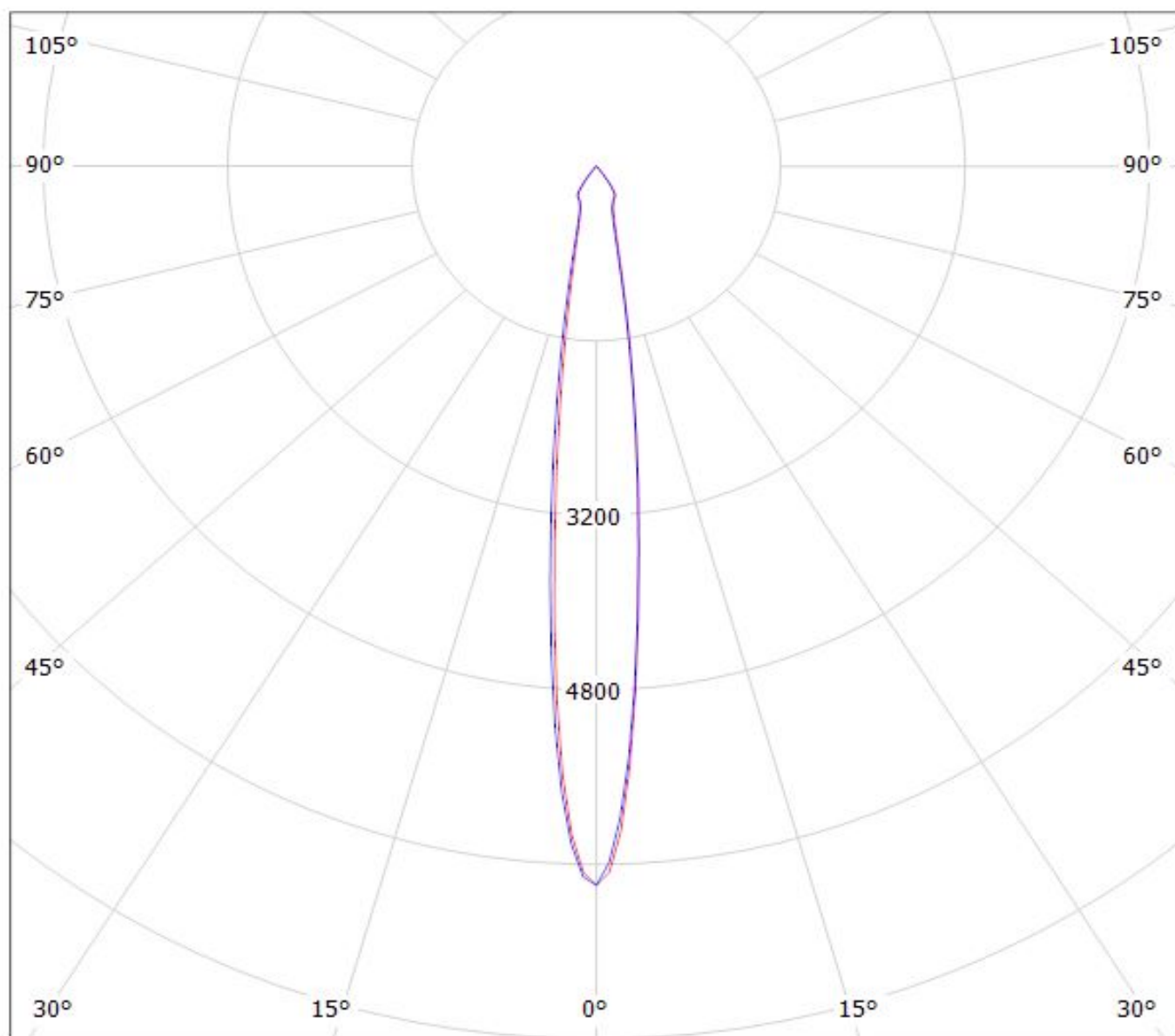

cd/klm

— C0 - C180

— C90 - C270

$\eta = 83\%$

Luminaire: LEDiL Oy CN13523_MIRELLA-50-S-CL-PF_(CREE_XHP50_WARM_WHITE)
Lamps: 1 x CREE_XHP50_WARM_WHITE_195.491lm@250mA_P=1.39994W_I=0.2499A

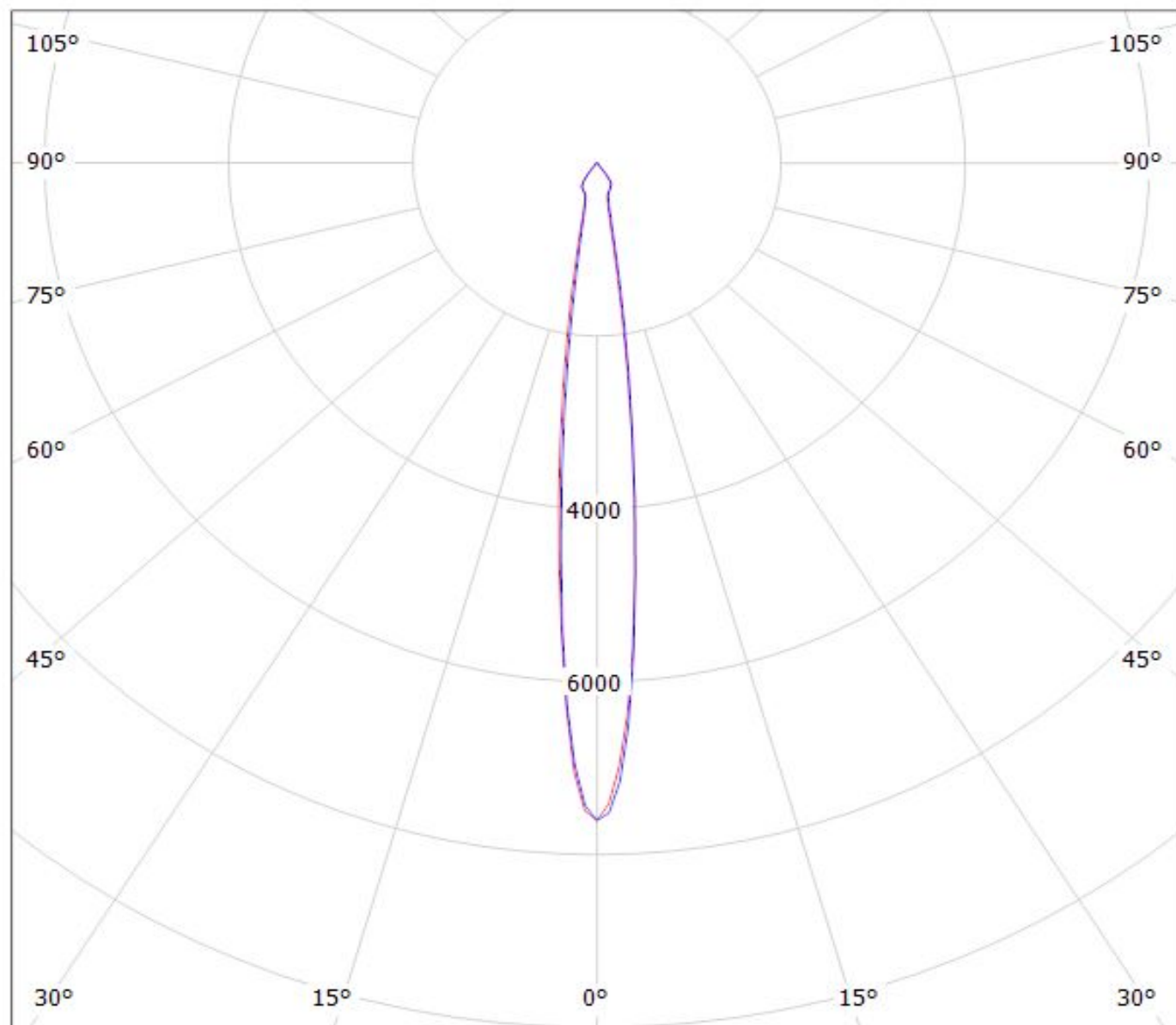

cd/klm

— C0 - C180

— C90 - C270

$\eta = 84\%$

Luminaire: LEDiL Oy CN13523_MIRELLA-50-S-CL-PF_(CREE_XHP70)
Lamps: 1 x CREE_XHP70_260.212lm@250mA_P=1.383W_I=0.2499A

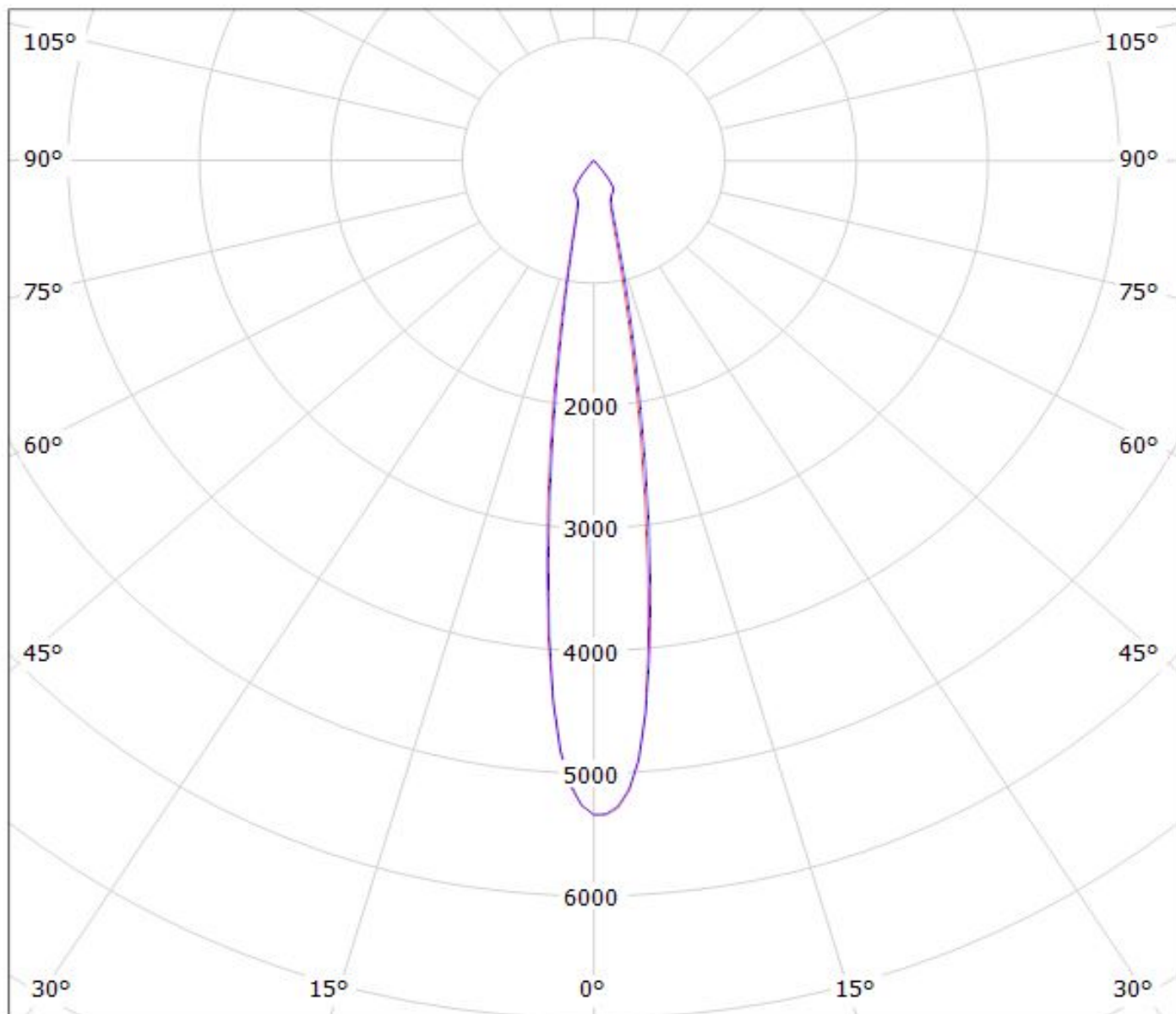

cd/klm

η = 83%

— C0 - C180

— C90 - C270

Luminaire: Ledil CN13523_MIRELLA-50-S-CL-PF_(MHD-G)
Lamps: 1 x Cree MHD-G_530.44lm@100mA_P=3.0W_I=0.100A

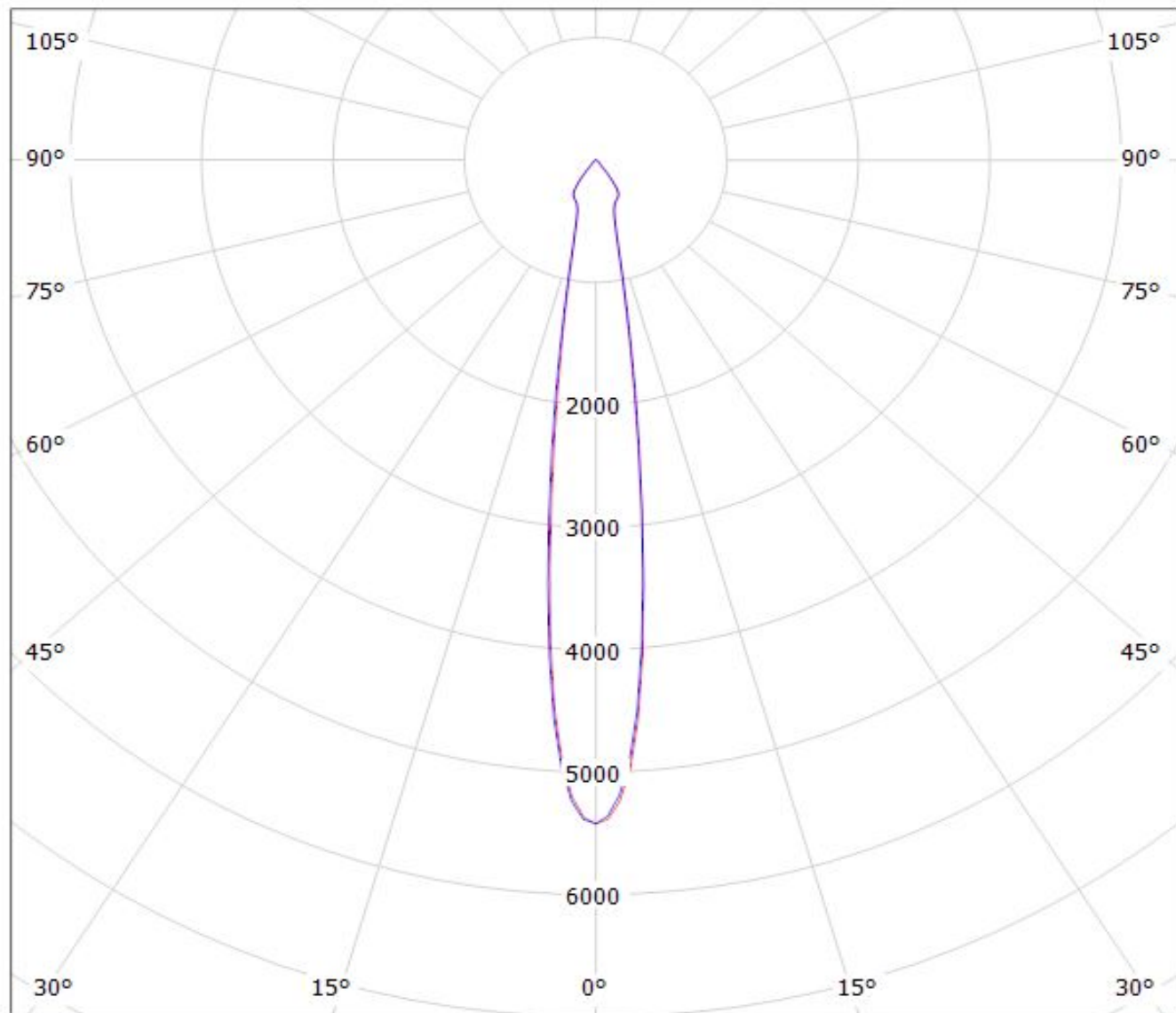

cd/klm

— C0 - C180 — C90 - C270

$\eta = 87\%$

Luminaire: LEDiL Oy CN13523_MIRELLA-50-S-CL-PF_(CXM-9)

Lamps: 1 x Luminus_XNOVA_CXM-9_(AA00)_974.297lm@240mA_P=8.2836W_I=240mA

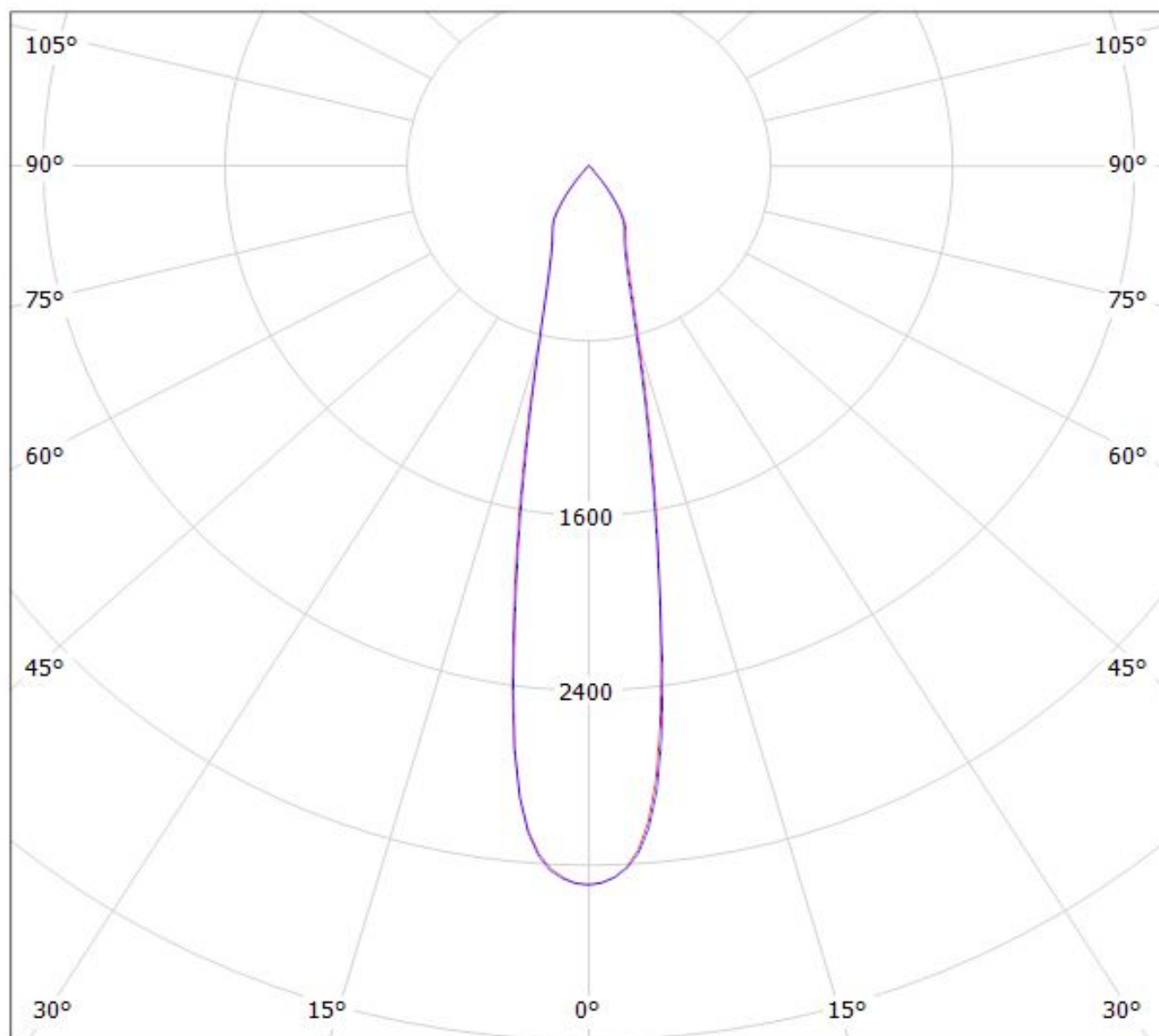

cd/klm

— C0 - C180

— C90 - C270

$\eta = 85\%$

Luminaire: Ledil CN13523_MIRELLA-50-S-CL-PF_(Duris_S10)

Lamps: 1 x Osram_Duris_S10_(GWP7LM32.CM)_298.59lm@100mA_P=2.52277W_I=0.1A

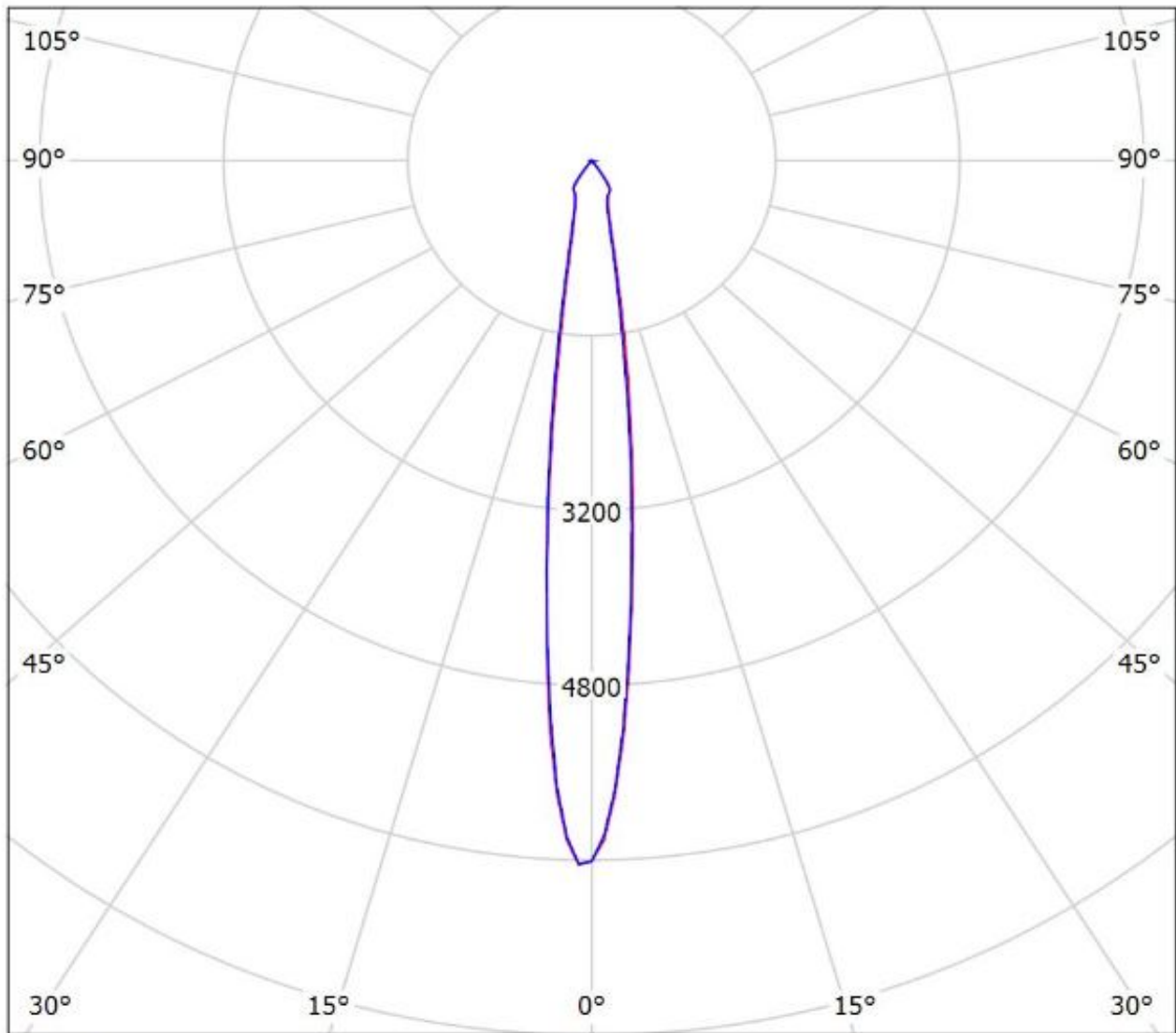

cd/klm

— C0 - C180 — C90 - C270

$\eta = 81\%$

Luminaire: Ledil Oy CN13523_MIRELLA-50-S-CL-PF_(Soleriq_S9)_SIMULATED
Lamps: 1 x Osram Soleriq S9 (GW KAFJB3.EM)

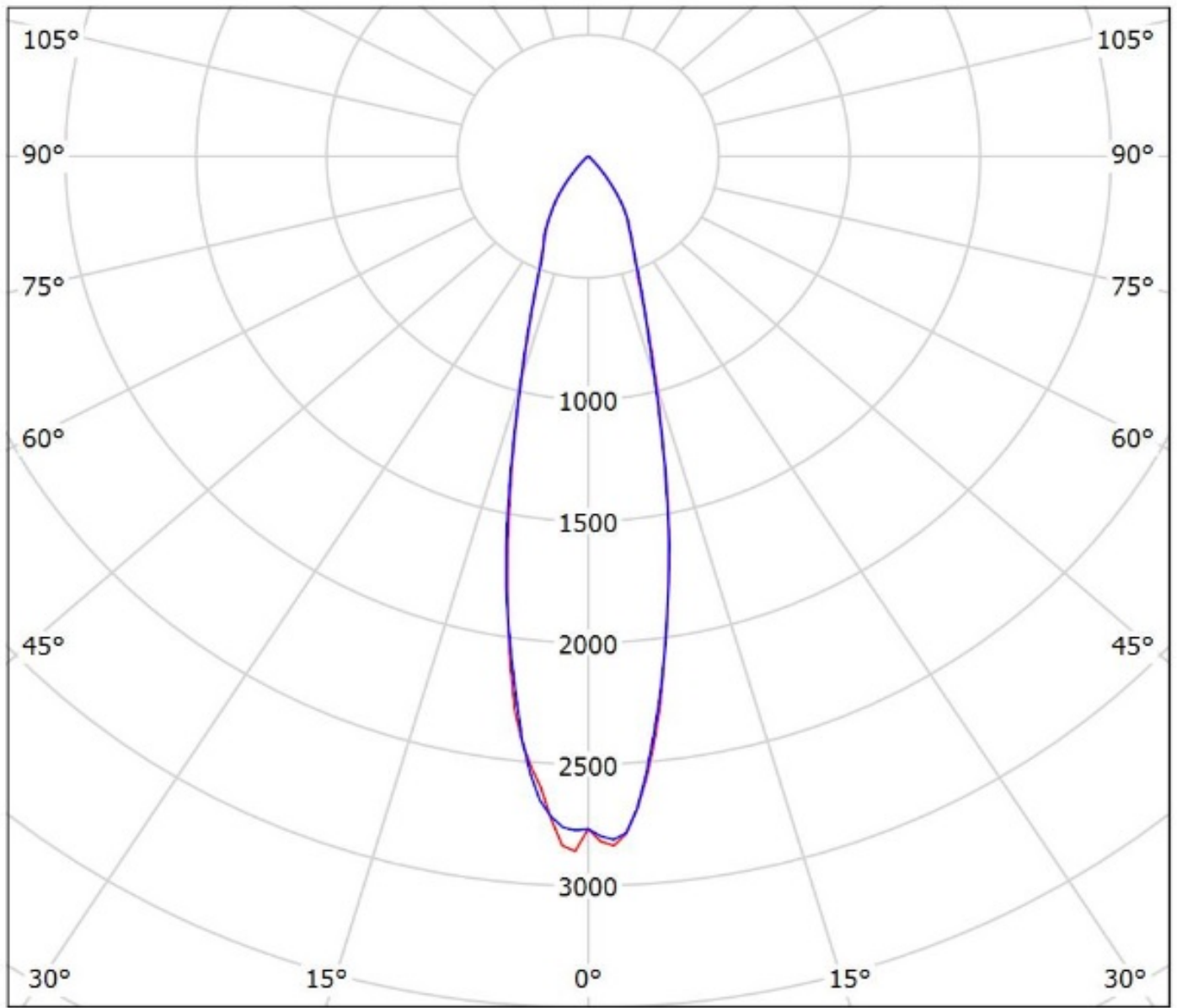

cd/klm
— C0 - C180 — C90 - C270

$\eta = 87\%$

Luminaire: LEDil Oy CN13523_MIRELLA-50-S-CL-PF_(ZC6) Efficiency=82%
Lamps: 1 x Seoul ZC6 (SDW81F1C) 422lm @ 100mA CCT=3100K P=3.4W I=100mA

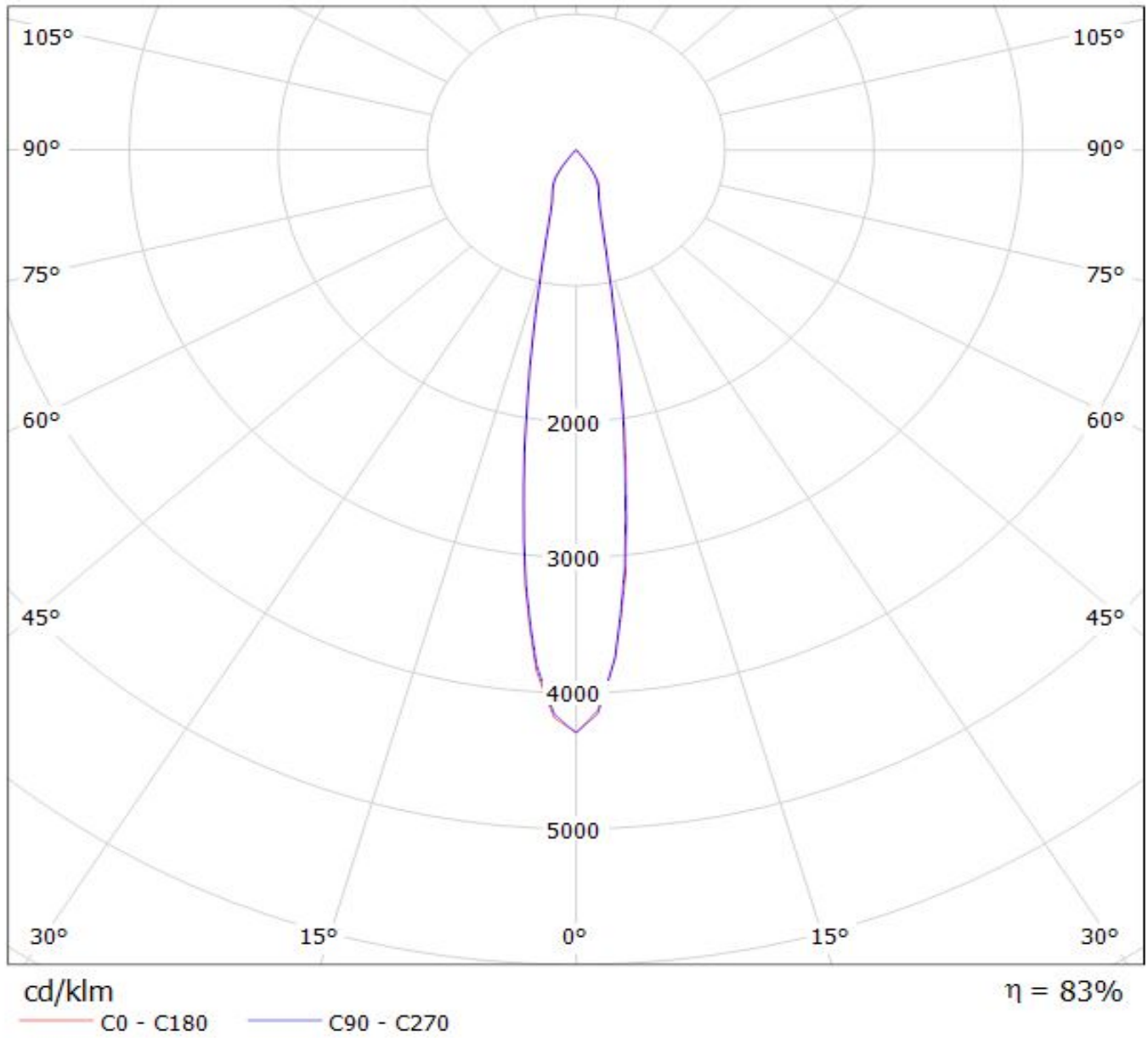

NOTE: The typical divergence will be changed by different color, chip size and chip position tolerance. The typical total divergence is the full angle measured where the luminous intensity is half of the peak value.

GENERAL INFORMATION

- Product series especially designed & optimized for series of LEDs.
- Special care taken to make light distribution as uniform as possible.

Note! Due to use of high power COB's with this product, special attention to proper thermal design is highly recommended. LEDiL has no liability for direct, indirect or consecutive damages arising from the LEDiL products being used outside of the recommended temperature range.