



Copyright FCI

1 | 2



FCIconnect.com



3



4

PRODUCT NUMBER  
SEE SHEET 2

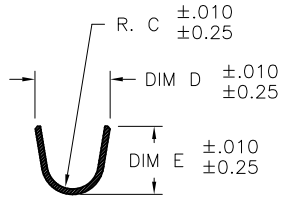

SECTION J-J  
SCALE 8:1

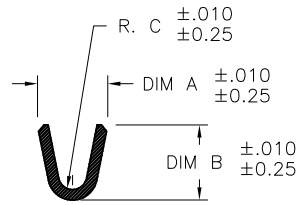

SECTION H-H  
SCALE 8:1

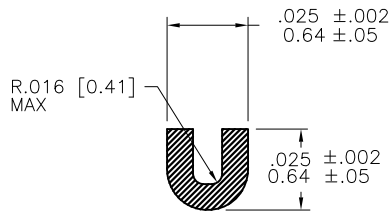

SECTION G-G  
SCALE 5:1

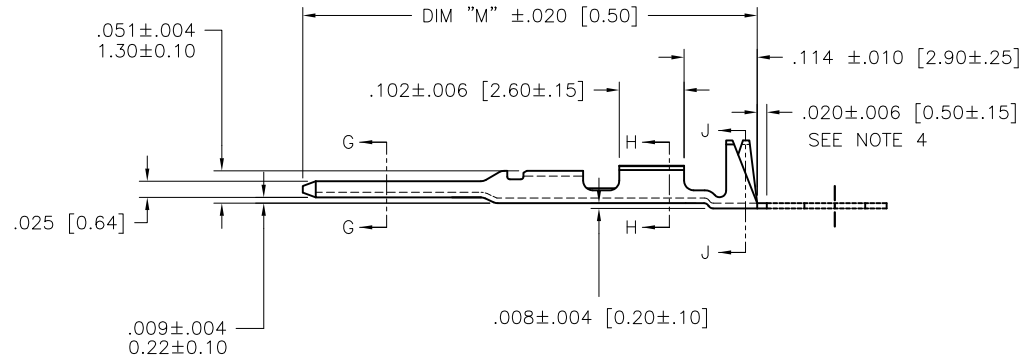
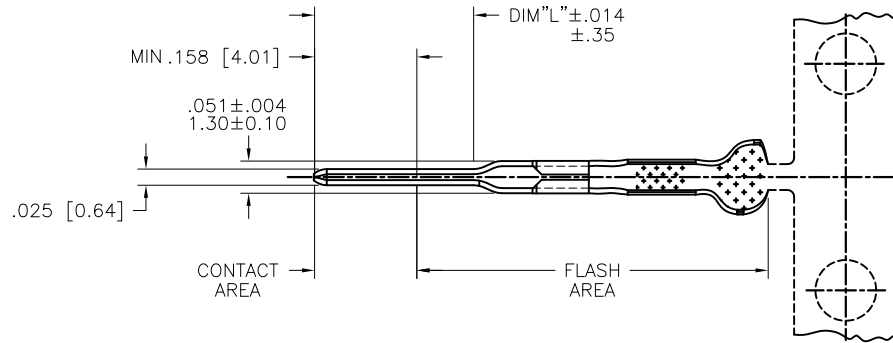

mat'l. code SEE NOTE 5				surface <input checked="" type="checkbox"/> tolerance		projection	product family PV TERMINALS	
ltr	ec'n no	dr	date	tolerances unless otherwise specified			title	
T	V09-0453	HTB	2009-10-15	angles	XX +.01/XX+3 XXX +.005/XXX+13		INCH/MM	C.T.W. MALE PIN
M	V05-0209	HTB	2005-03-01	0° ±2'	XXXX +.0020/XXX+.051	scale 4:1	sheet 1 of 2 size	
N	V05-0467	HTB	2005-05-23	dr	S. ROYER		sheet 1 of 2 size	
P	V05-0530	HTB	2005-05-31	engr	T. HANNA		75967 A4	
R	V06-0624	HTB	2006-06-30	chr	T. HANNA		type CUSTOMER Drawing	
S	V08-0114	HTB	2008-04-01	appd	T. HANNA			
sheet index	revision	T	T					
	sheet	1	2					

form: A4mmXLC

1

2

3

4

PRODUCT NUMBER	AWG	WIRE BARREL			INSULATION BARREL				DIM "L"	DIM "M"
		DIM "A"	DIM "B"	DIM "C"	DIM "D"	DIM "E"	DIM "F"			
75967-XY1		O B S O L E T E								
75967-XY1LF	28-32	.054/1.37	.058/1.47	.011/0.28	.115/2.92	.105/2.67	.040/1.02	.253/6.42	.697/17.70	
75967-XY2		O B S O L E T E								
75967-XY2LF	22-26	.070/1.78	.070/1.78	.017/0.43	.139/3.53	.120/3.05	.050/1.27	.253/6.42	.697/17.70	
75967-XY3		O B S O L E T E								
75967-XY3LF	18-20	.104/2.64	.104/2.64	.021/0.53	.139/3.53	.120/3.05	.050/1.27	.253/6.42	.697/17.70	
75967-XY7		U N A V A I L A B L E								
75967-XY8		U N A V A I L A B L E								
75967-XY9		U N A V A I L A B L E								

PRODUCT NUMBER

75967-XYZLF

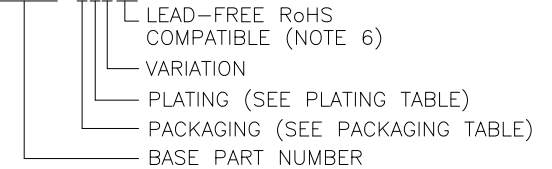

PLATING CODE	PLATING
75967-X1ZLF	30μ"/0.76μ Au IN CONTACT AREA; REMAINDER 3μ"/0.076μ Au FLASH OVER 50μ"/1.27μ Ni
75967-X2ZLF	15μ"/0.38μ Au IN CONTACT AREA; REMAINDER 3μ"/0.076μ Au FLASH OVER 50μ"/1.27μ Ni
75967-X3ZLF	50μ"/1.27μ Au IN CONTACT AREA; REMAINDER 3μ"/0.076μ Au FLASH OVER 50μ"/1.27μ Ni
75967-X6Z	O B S O L E T E
75967-X6ZLF	PRE-PLATED 100μ"/2.54μ TO 160μ"/4.06μ Sn (NOTE 8)
75967-X9ZLF	50μ"/1.27μ Au IN CONTACT AREA; REMAINDER 30μ"/0.76μ Au OVER 50μ"/1.27μ Ni

NOTES:

1. APPLICABLE SPECIFICATIONS  
BUS-12-098 PRODUCT SPECIFICATION
2. FOR PLATING SPECIFICATIONS SEE SHEET 2
3. FOR APPLICATION WITH MINI-LATCH HOUSING SEE TA-211
- ④ CUT-OFF DIMENSION FOR LOOSE-PIECE VERSIONS
- ⑤ MATERIAL: BRASS ASTM B36 ALLOY C26000-H03
- ⑥ PRODUCT MEETS EUROPEAN UNION DIRECTIVES AND OTHER COUNTRY REGULATIONS AS DESCRIBED IN GS-22-008.
7. THIS PRODUCT IS NOT INTENDED TO BE EXPOSED TO MANUFACTURING SOLDER PROCESSES.
- ⑧ THIS PRODUCT HAS 100% TIN PLATING IN THE INTERFACE AND HAS NOT BEEN TESTED FOR WHISKER GROWTH IN ALL INTERCONNECT ENVIRONMENTS.

PACKAGING CODE	FINAL REELING	QUANTITY	APPLICATION INFORMATION
75967-OYZLF	LOOSE PIECE	U N A V A I L A B L E	
75967-1YZLF	RIGHT TO LEFT	8000 PER REEL	APPLICATOR R. TO L. FEEDING
75967-3YZLF	LEFT TO RIGHT	8000 PER REEL	APPLICATOR L. TO R. FEEDING
75967-4YZLF	LEFT TO RIGHT	250 PER REEL	HANDTOOL SMALL REEL

mat'l. code SEE NOTE 5		surface <input checked="" type="checkbox"/> tolerance		projection		product family PV TERMINALS	
ltr	ecn no	dr	date	tolerances unless otherwise specified		title C.T.W. MALE PIN	
T				angles	$.XX \pm 0.1/XX \pm 3$ $.XXX \pm 0.05/XX \pm 13$	INCH/MM	
				0° ±2'	XXXX ±0.020/XXX±0.051	scale 4:1	
		dr	S. ROYER	1994-12-19		dwg no	
		enr	T. HANNA	1994-12-19		sheet 2 of 2 size	
		chr	T. HANNA	1994-12-19		75967 A4	
		appd	T. HANNA	1994-12-19		type CUSTOMER Drawing	
sheet index	revision sheet						