

PRODUCT NUMBER	EQUIVALENT METRAL SIGNAL HEADER PIN LENGTH	ROHS COMPATIBILITY
10009536-001	8.0	N/A
10009536-002	6.5	N/A
10009536-003 *	5.0	N/A
10009536-001LF	8.0	SEE NOTE 9
10009536-002LF	6.5	SEE NOTE 9
10009536-003LF *	5.0	SEE NOTE 9

\* SEE NOTE 7

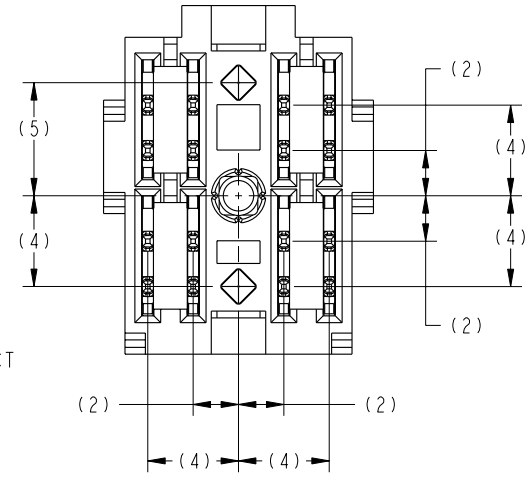
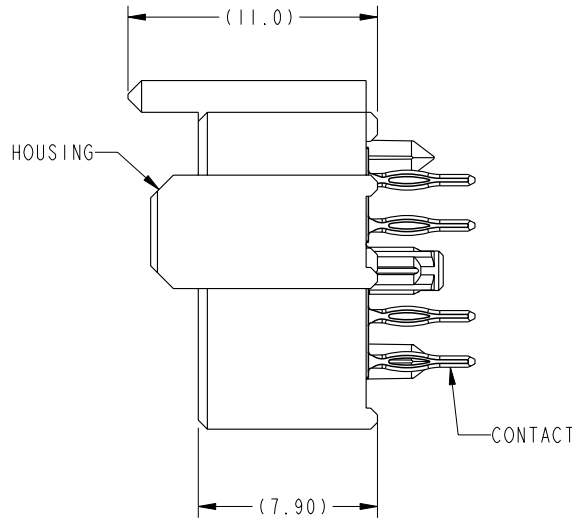
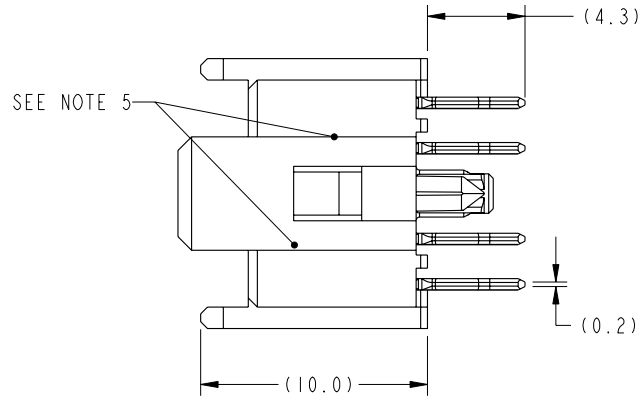
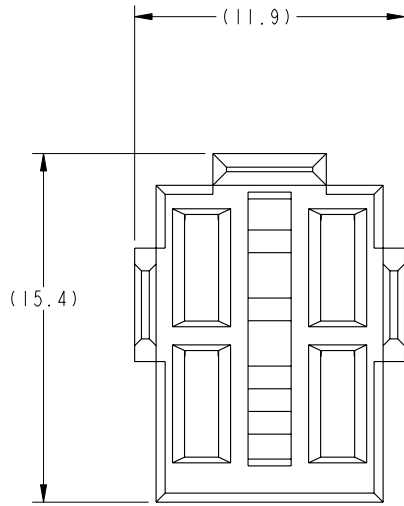

Copyright FCI.

www.fciconnect.com		surface ASME Y14.5	tolerance std -	projection mm
		TOLERANCES UNLESS OTHERWISE SPECIFIED		mm
Dr	T. BRUNGARD	2002-07-12	ANGULAR	size A4
Eng	ANDREW YONG	2010-05-11	LINEAR	Scale 3:1
Chr	C.H. TAN	2010-05-11	0° ±2°	ECN S10-0086
Appr	JOEY NG	2010-05-11	Product family 2mm HI POWER	Spec ref -
FCI		RECEPTACLE ASSEMBLY		dwg no 10009536
		PRESS-FIT, METRAL VERSION		Rev. H
catalog no		-		CUSTOMER
				sheet 1 of 2

rev	ecn no	dr	date
H	S10-0086	AY	2010-05-11
-	-	-	-
C	V03-0752	GIP	2003-08-19
D	V04-0115	DAI	2004-02-05
E	S05-0300	MC	2005-10-21
F	S06-0412	LS	2006-12-21
G	S09-0319	YK	2009-10-14

TOP LAYER DESCRIPTION	TABLE I PLATED THROUGH-HOLE REQUIREMENTS							
	DRILLED HOLE DIAMETER	COPPER THICKNESS	TIN-LEAD THICKNESS	NICKEL THICKNESS	GOLD THICKNESS	TIN THICKNESS	SILVER THICKNESS	FINISHED HOLE DIAMETER (DIM "A") <sup>H</sup>
TIN-LEAD	0.81-0.86 (0.85 DRILL)	0.025 - 0.050	0.005 - 0.015	--	--	--	--	0.65 - 0.80
IMMERSION TIN	0.81-0.86 (0.85 DRILL)	0.025 - 0.050	--	--	--	0.9 - 1.5 $\mu$ m	--	0.70 - 0.80
IMMERSION SILVER	0.81-0.86 (0.85 DRILL)	0.025 - 0.050	--	--	--	--	0.15 - 0.65 $\mu$ m	0.70 - 0.80
COPPER (SEE NOTE 11)	0.81-0.86 (0.85 DRILL)	0.025 - 0.050	--	--	--	--	--	0.70 - 0.80
GOLD	0.81-0.86 (0.85 DRILL)	0.025 - 0.050	--	0.003 - 0.007	FLASH UP TO 0.0002	--	--	0.69 - 0.80

NOTES:

1. CONNECTOR MATERIALS:  
HOUSING: HIGH TEMPERATURE THERMOPLASTIC, BLACK, UL94V-0 COMPLIANT.  
CONTACT: HIGH PERFORMANCE COPPER ALLOY
2. CONTACT PLATING:  
PRESS-FIT TAIL: 0.5-1.5 $\mu$ m TIN-LEAD OVER NICKEL (LEADED)  
: 0.5-1.5 $\mu$ m MATTE TIN OVER NICKEL (LEAD FREE)  
SEPARABLE INTERFACE: 0.76 $\mu$ m MIN GOLD OVER NICKEL
3. PRODUCT SPECIFICATION: GS-12-220
4. APPLICATION SPECIFICATION: GS-20-023
5. PRODUCT MARKING (PRODUCT NUMBER & LOT CODE) ON THESE SURFACES.
6. INDICATED HOLES ARE UNPLATED.
7. -003 AND -003LF WILL NOT BE TOOLED INITIALLY.
8. "LF" SUFFIX DENOTES LEAD FREE PLATING.
9. PRODUCT MEETS EUROPEAN UNION DIRECTIVES AND OTHER COUNTRY REGULATIONS AS DESCRIBED IN FCI SPECIFICATION GS-22-008.
10. PACKAGING MEETS FCI SPECIFICATION GS-14-920.
11. COPPER PLATING THICKNESS AT CENTER OF VIA HOLE CAN BE NO MORE THAN 0.003 LESS THAN OTHER AREAS.
12. KEEPOUT AREA CORRESPOND TO MATING HEADER OUTLINE WITH 13.2MM HEIGHT ABOVE TOP SURFACE OF DAUGHTER CARD AND 4.60MM BELOW TOP SURFACE OF DAUGHTER CARD
13. A <sup>H</sup> SYMBOL WILL BE NEXT TO ANY DIMENSION, VIEW, OR NOTE WHICH HAS BEEN MODIFIED WITH THE CURRENT DRAWING REVISION

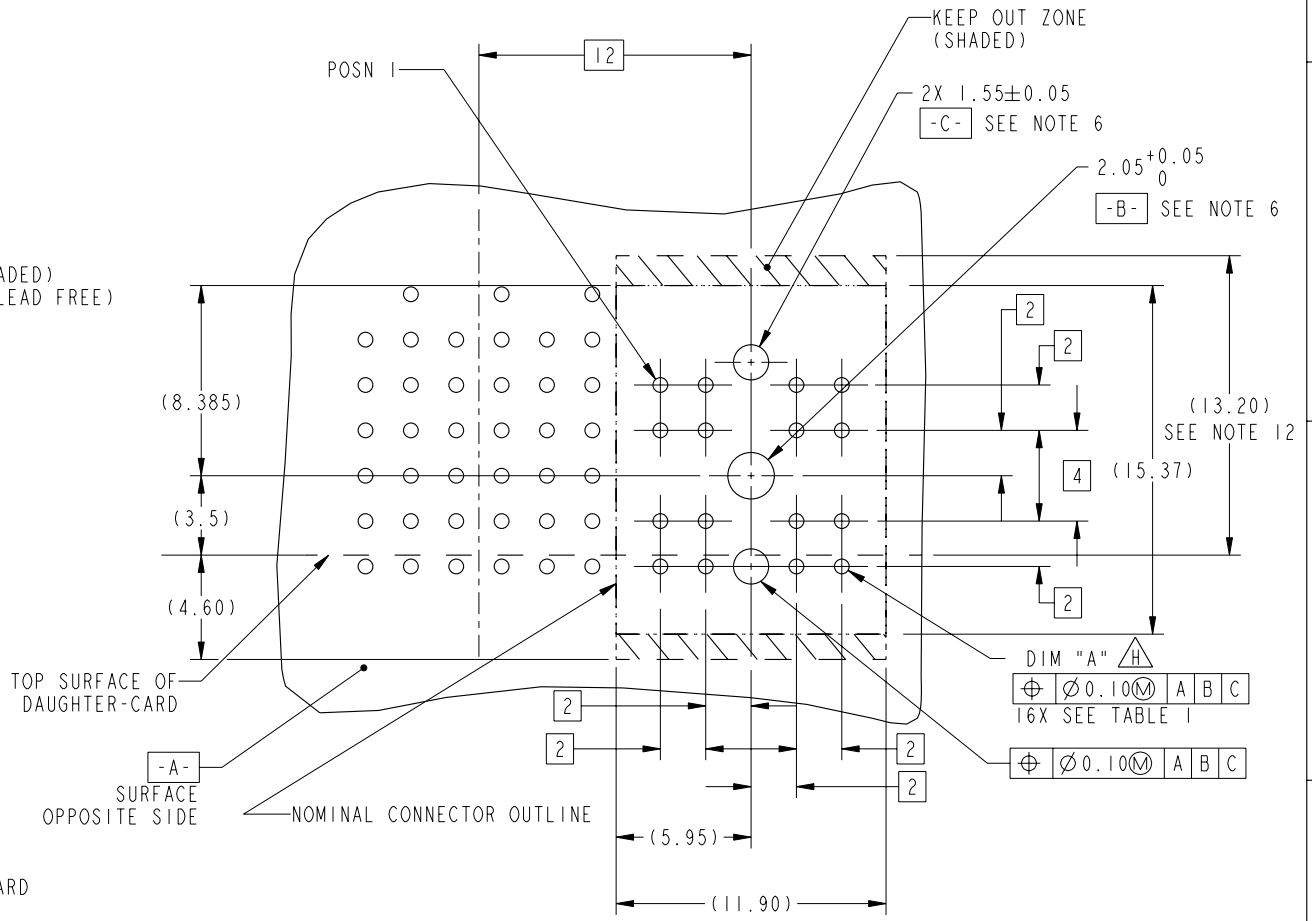

RECOMMENDED PCB LAYOUT,  
COMPONENT SIDE  
(SHOWN BESIDE A 5 ROW METRAL 1000 HEADER)

FCI	RECEPTACLE ASSEMBLY	dwg no	10009536	Rev.	H
	PRESS-FIT, METRAL VERSION		CUSTOMER		sheet 2 of 2
catalog no					



Copyright FCI.